

LEE BROOM

CRYSTAL BULB

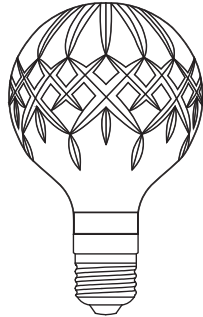

CONTENTS

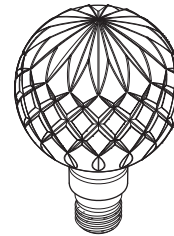

1 x Crystal Bulb & 1 x E26 2w LED Bulb

ATTENTION! BEFORE YOU START

- Ensure power supply is disconnected prior to installation.
- This product is for interior use only and should be installed in a dry environment only.
- Bulb is supplied.
- When switched on the Crystal Bulb may become hot.
- Please read the instructions carefully before you commence install and retain them for future reference.

EN **IMPORTANT** Please only use 2 watt LED. DO NOT use with a halogen bulb.

FR **IMPORTANT** A utiliser uniquement avec une LED de 2 watt. Priere de ne pas utiliser avec une ampoule halogene.

DE **WICHTIG** Bitte verwenden sie ausschliesslich 2 watt LED. Verwenden sie kiene halogenlampe.

ES **IMPORTANTE** Por favor utilizar unicamente LED de 2 vatios. No utilizar con bombilla halógena.

DA **VIGTIGT** Vennligst avend kun 2 watt LED. Må ikke anvendes med halogenpære.

SE **VIGTIGT** Använd endast 2 watt LED. Använd inde halogenlampa.

NL **BELANGRIJK** Gelieve alleen 2 watt LED te gebruiken. Gebruik géén halogeen lamp.

IT **IMPORTANTE** Utilizzare unicamente 2 watt LED. Non usare con una lampadina alogena.

EL ΠΡΟΣΟΧΗ: ΠΑΡΑΚΑΛΩ ΧΡΗΣΙΜΟΠΟΙΗΣΤΕ ΜΟΝΟ ΜΕ LED 2 WATT. ΝΑ ΜΗ ΧΡΗΣΙΜΟΠΟΙΗΘΕΙ ΜΕ ΛΑΜΠΑ ΑΛΟΓΟΝΟΥ.

ZH 重要提示：請使用2瓦的LED，請勿使用鹵素燈泡。

ASSEMBLY

Screw the Crystal Bulb unit into any standard E26 lamp holder to illuminate the Crystal Bulb.

BULB REPLACEMENT

- Please visit WWW.LEEBROOM.COM to purchase replacement E26 2w LED Bulbs.
- **DO NOT** use with a halogen bulb.
- Maximum wattage 2w LED, 110-130v.
- Make sure the Crystal Bulb is switched off and ensure the Crystal Bulb unit has cooled down before handling.

- To replace bulb:
 - i. Unscrew the Crystal Bulb unit from the light fitting.
 - ii. Unscrew the E26 2w LED Bulb from the Crystal Bulb globe.
 - iii. Screw new E26 2w LED Bulb into the Crystal Bulb globe.
 - iv. Finally screw the Crystal Bulb unit back into the light fitting.

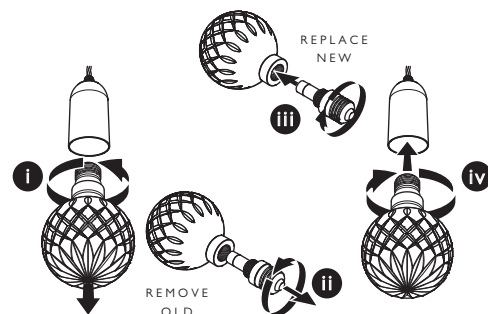

CARE AND CLEANING

- Only clean when the Crystal Bulb is switched off.
- Please allow a suitable cooling period before cleaning.
- Only use a non-abrasive, soft, dry cloth when cleaning the Crystal Bulb.

For more information please contact:

US & Canada Inquiries: +1 212 804 8477 - 34 Greene Street, New York, NY 10013 - sales@leebroom.com

UK & Global Inquiries: +44 207 820 0742 - 95 Rivington Street, London, EC2A 3AY - info@leebroom.com

WWW.LEEBROOM.COM

