

ECLIPSE COLLECTION
EXTERIOR TALL WALL SCONCE



INSTALLATION GUIDE
NORTH AMERICA

ARTICOLO

CLEANING GUIDE

ANODISED
To preserve the surface finish, regular care should be taken. Please use a warm damp cloth to remove any marks or residue.

GLASS
For clear and coloured glass, wipe gently with a soft clean cloth moistened with warm water; 'Isocol' rubbing alcohol may alternatively be used.
For frosted or etched glass, dust gently with a duster or soft rag. Do not scrub frosted glass. Removeable shades can be washed carefully in warm to hot water in the sink with minimal cleaning solution.

WARRANTY

Articolo Lighting fixtures are warranted for 3 years after receipt (not installation) against defects. Articolo Lighting will repair or replace defective components or product. Hardwired light fixtures are certified for UL and CE dry locations.

ARTICOLO IS NOT RESPONSIBLE FOR

- Damage caused by improper cleaning solutions or methods.
- Damage caused by improper installation or assembly by the customer or the customer's agent.
- Damage to our fixtures, parts of our fixtures, or shades caused by the improper use of light bulbs.
- Damage caused by exposure to weather or improper environment.
- Changes in the appearance of the hand rubbed finishes or un-lacquered finishes. These are meant to age in appearance.
- Any costs of installation, removal or re-installation.

+1 (646) 971 0065
INFO@ARTICOLOSTUDIOS.COM
ARTICOLOSTUDIOS.COM



ELEVATIONS

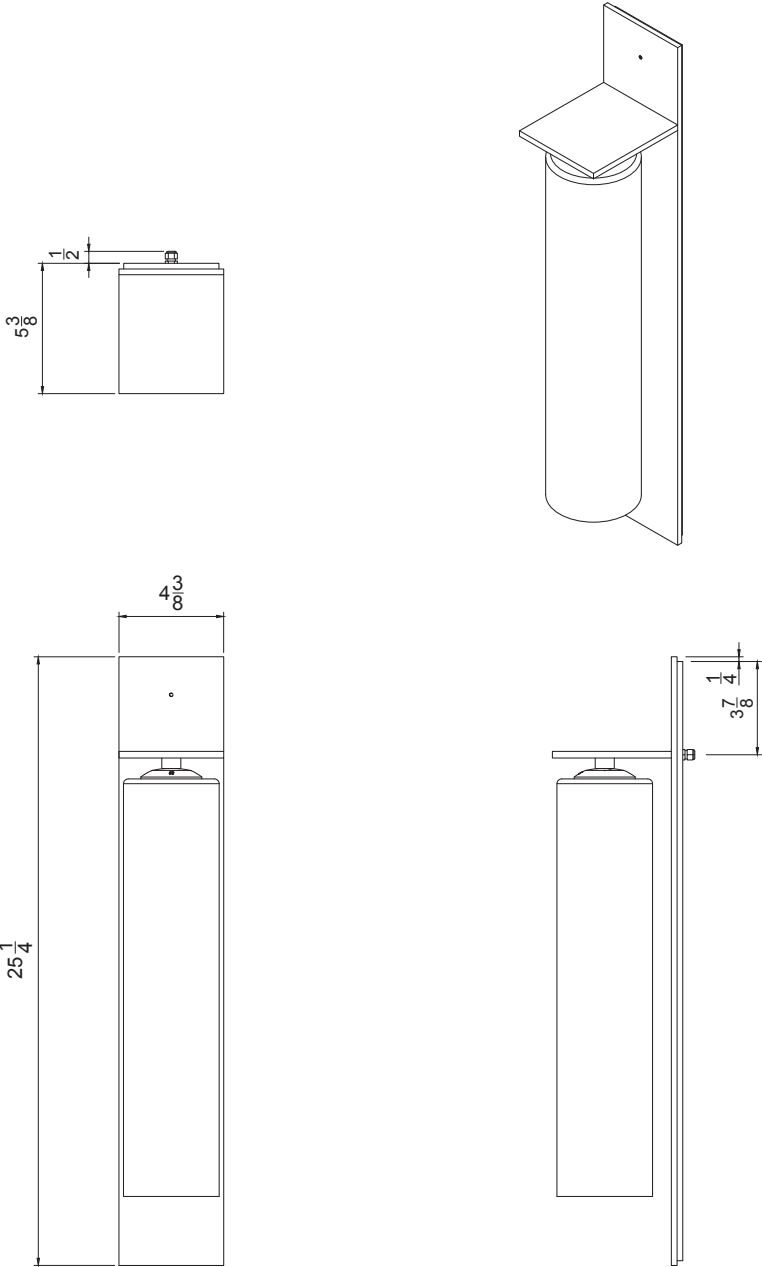

BACKPLATE

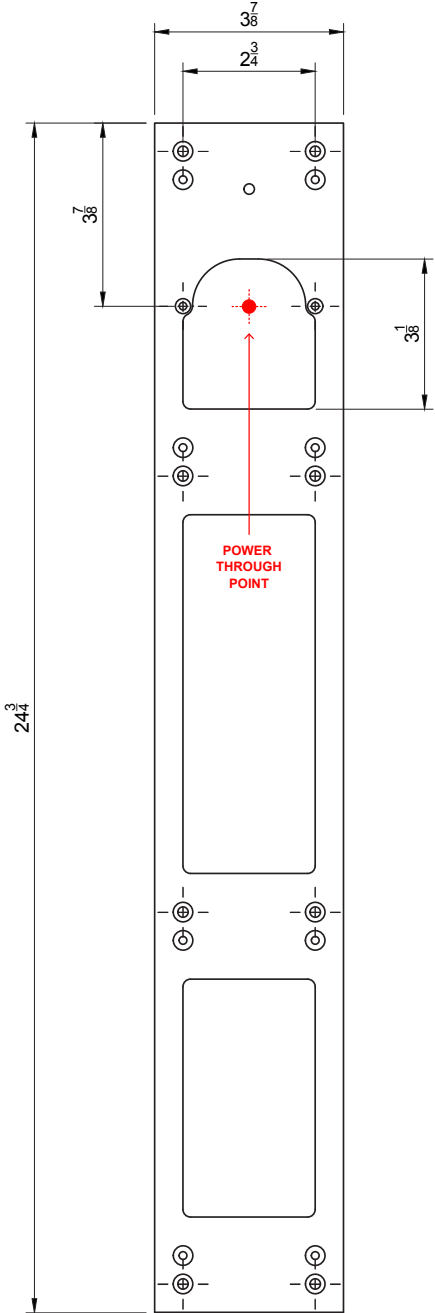
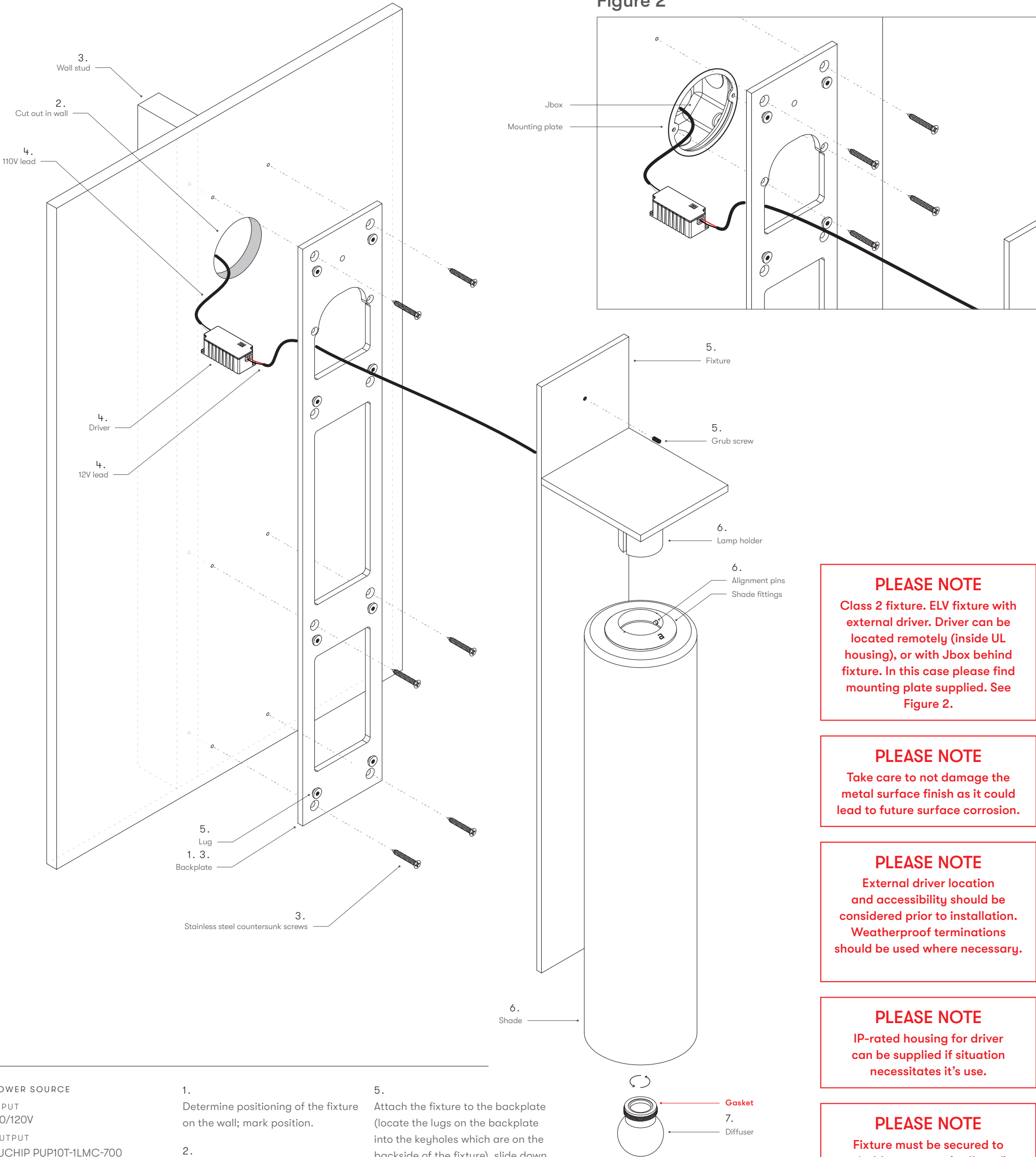

Figure 2



POWER SOURCE

INPUT
110/120V

OUTPUT
EUCHIP PUP10T-1LMC-700
(500mA)

LIGHT SOURCE
6W LED Board 500mA 11.5Vf DC
(constant current) 2700K 400lm

WEIGHT
7 lb

IP RATING
IP 65

- Determine positioning of the fixture on the wall; mark position.
- Make cut out in the wall suitable for fixture protrusion beyond the rear of the backplate. Use the backplate as a template to ensure hole is made where wiring exits the fixture.
- Fix the backplate in position with stainless steel countersunk screws; **ensure fixture is secured to the structure (wall stud for example).**
- Connect the fixture to the driver. Connect the driver to the power supply. House the driver in a UL approved electrical box; driver can be housed up to 30m away.
- Attach the fixture to the backplate (locate the lugs on the backplate into the keyholes which are on the backside of the fixture), slide down into position. Secure in place with grub screw.
- Raise shade up to the lamp holder; align pins in the shade fittings to the grooves on the lamp holder. Slide up and twist anti-clockwise to secure in position.
- Thread diffuser into lamp holder; ensure it is appropriately tightened (**please note - rubber gasket creates a waterproof seal).**

CAUTION
Please note: ELV (Extra Low Voltage) fixture

SUITABLE FOR
OUTDOOR USE

IP 65

WARNING
This product must be installed by a licensed electrician in accordance with the wiring rules.

Control gear to be used with this product must be 500mA constant current 12Vdc minimum and suitably approved to Australian standards and listed with the Australian EESS scheme

Strict adherence to the installation instructions is required to meet "NEC" and "UL" compliance

Do not discard product (where applicable) with general waste. Reuse or recycle Waste Electrical and Electronic Equipment (WEEE) by disposing at a designated collection facility.

PLEASE NOTE

Class 2 fixture. ELV fixture with external driver. Driver can be located remotely (inside UL housing), or with Jbox behind fixture. In this case please find mounting plate supplied. See Figure 2.

PLEASE NOTE

Take care to not damage the metal surface finish as it could lead to future surface corrosion.

PLEASE NOTE

External driver location and accessibility should be considered prior to installation. Weatherproof terminations should be used where necessary.

PLEASE NOTE

IP-rated housing for driver can be supplied if situation necessitates it's use.

PLEASE NOTE

Fixture must be secured to suitable structure (wall stud).

PLEASE NOTE

Be sure to make cut out sufficient to accommodate fixture protrusion beyond rear of Backplate.