

# LEE BROOM

## MINI CRESCENT TABLE LAMP

US: CRE0150

CONTENTS

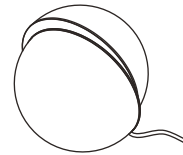
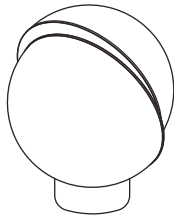

1 x Mini Crescent Shade

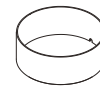

1 x Table Lamp Base



1 x LED Bulb



1 x Allen Key

### ATTENTION! BEFORE YOU START

For safety please read these instructions carefully before you commence install and retain them for future reference.

- Ensure mains power supply is disconnected prior to installation.
- Install according to latest NEC wiring regulations.
- This product is for interior use only and should be installed in a dry environment only.
- Bulb is supplied.
- When switched on Mini Crescent may become hot.

### TECHNICAL

110-130V ~ 60Hz; E26 MAX 25W LED



For more information, please contact:

US & Canada Inquiries: +1 212 804 8477 - [sales@leebroom.com](mailto:sales@leebroom.com)

UK & Global Inquiries: +44 207 820 0742 - [info@leebroom.com](mailto:info@leebroom.com)

### BULB REPLACEMENT

- Visit [www.leebroom.com](http://www.leebroom.com) to purchase recommended replacement.
- Maximum wattage E26 25W LED, 110-130V.
- Ensure Mini Crescent is switched off & cooled down before handling.
- To replace bulb:
  - To access the old bulb repeat assembly steps 1-3.
  - Unscrew and remove the old bulb.
  - To fit replacement bulb, repeat assembly steps 4-6.

### RECYCLING ELECTRICAL PRODUCTS

Lee Broom encourages all customers to notice this symbol  and avoid putting any waste electrical goods in domestic waste bins or containers. Please ensure waste electrical goods are disposed of at a suitable facility.

### CARE AND CLEANING

- Only clean when Mini Crescent is switched off.
- Please allow a suitable cooling period before cleaning.
- Only use a non-abrasive, soft, dry cloth when cleaning Mini Crescent.

### ASSEMBLY

DISCONNECT ALL MAINS POWER SUPPLY WIRES BEFORE INSTALLATION.

1.

Unscrew and remove the grub screw from the side of the Mini Crescent shade. Use the allen key supplied. Ensure to retain the grub screw for reassembly.

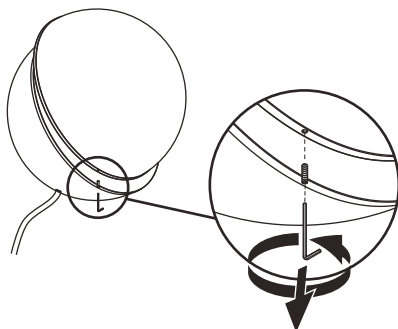

2.

Separate the Mini Crescent shade by first sliding up the lower half flush with the top half.

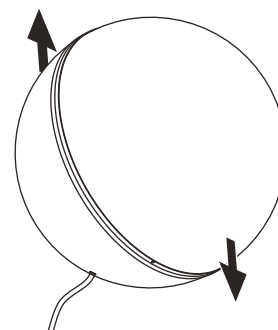

## ASSEMBLY

3.

Pull the two halves apart.

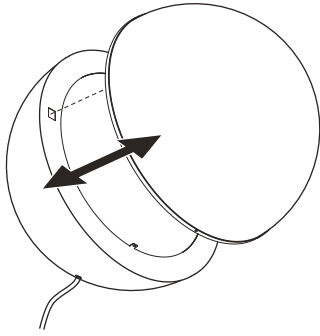

4.

First remove internal packaging from inside shade. Then fit supplied bulb into lamp holder. The supplied bulb is recommended by Lee Broom for correct brightness and colour temperature. Alternative bulbs are available.

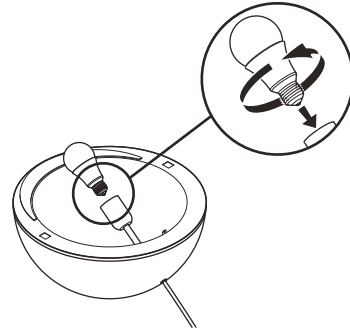

5.

- Position two halves flush together simultaneously locating the tab and two hooks into the square holes.
- Slide the half with the two hooks so that the hooks latch into position.

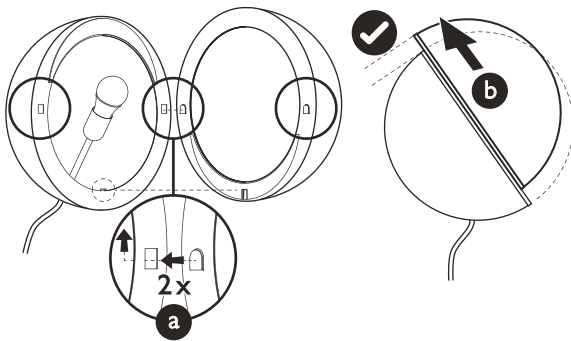

6.

Insert and screw the grub screw back into the side of the shade to ensure both halves are fixed securely.

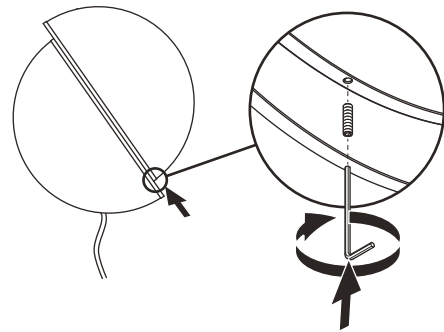

7.

Feed the electrical cord, inline switch and plug from the Mini Crescent shade completely through the table lamp base.

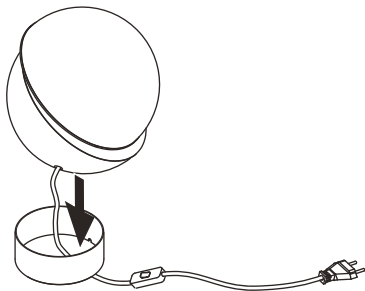

8.

Ensure the electrical cord is placed through the cable exit hole of the base before the Mini Crescent shade is positioned on top of the base.

