

LLADRÓ

Mokuren chandelier · 昌德利尔

REF. 01024261 - (CCC)
REF. 01024260 - (JP)
REF. 01024259 - (US)
REF. 01024258 - (CE/UK)

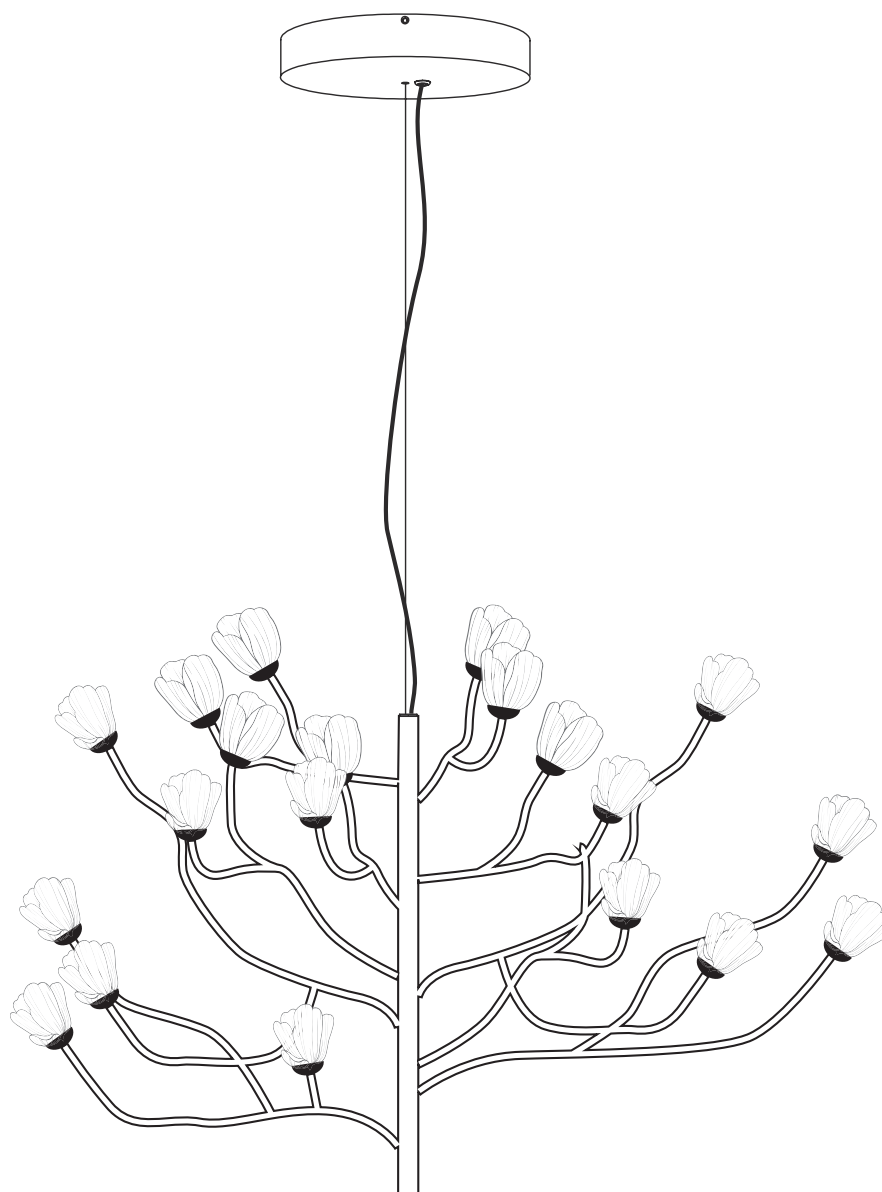



SAFETY ADVICE/ AVISO DE SEGURIDAD / 安全提示

EN: THE INSTALLATION OF THIS LIGHTING PRODUCT IMPLIES WORKING WITH HIGH VOLTAGE CURRENT. IF YOU ARE NOT AWARE OF THE SAFETY MEASURES INVOLVED, PLEASE ASK A CERTIFIED ELECTRICIAN TO DO THE WORK.

ES: LA INSTALACIÓN DE ESTA LUMINARIA SUPONE TRABAJAR CON UN NIVEL DE VOLTAJE PELIGROSO. SI USTED NO ESTÁ AL TANTO DE LAS MEDIDAS DE SEGURIDAD QUE SE DEBEN TOMAR, POR FAVOR PIDA A UN PROFESIONAL CUALIFICADO QUE REALICE LA INSTALACIÓN.

CH: 本款灯饰产品的安装需接入高压电流。如果您不了解相关安全措施，请交由专业电工操作。

EN: IF THE EXTERNAL CORD IS DAMAGED, IT MUST BE REPLACED ONLY BY A QUALIFIED PERSON ASWELL. THIS LUMINAIRE IS FOR INDOOR USE ONLY.

ES: SI EL CABLE FLEXIBLE O CORDÓN EXTERIOR DE ESTA LUMINARIA ESTÁ DAÑADO, DEBE SUSTITUIRSE EXCLUSIVAMENTE POR EL FABRICANTE O SU SERVICIO TÉCNICO (O UNA PERSONA DE CUALIFICACIÓN EQUIVALENTE), CON EL OBJETO DE EVITAR CUALQUIER RIESGO. LUMINARIA SOLO APTA PARA USO INTERIOR.

CH: 外部电源线如有损坏，请务必交由专业人士更换。本款灯饰仅供室内使用。

EN: THE LIGHT SOURCE CONTAINED IN THIS LUMINAIRE SHALL ONLY BE REPLACED BY THE MANUFACTURER OR HIS SERVICE AGENT OR A SIMILAR QUALIFIED PERSON.

ES: LA FUENTE DE LUZ QUE CONTIENE ESTA LUMINARIA SÓLO PUEDE SER REMPLAZADA POR EL FABRICANTE O SU SERVICIO TÉCNICO O UNA PERSONA DE CUALIFICACIÓN EQUIVALENTE.

CH: 此灯具内的光源应有由制造商或其服务商或有类似资格的人来更换





**CHECK YOUR
CEILING MAXIMUM LOAD**
VÉRIFIER LA CHARGE MAXIMALE
DE VOTRE PLAFOND



检查你的天花板最大负荷

Version 版本	Weight (W) 重量 (W)	W/3x	4 Sec. factor x4 安全系数
Mokuren	6.5 Kg	2.2 Kg	9 Kg

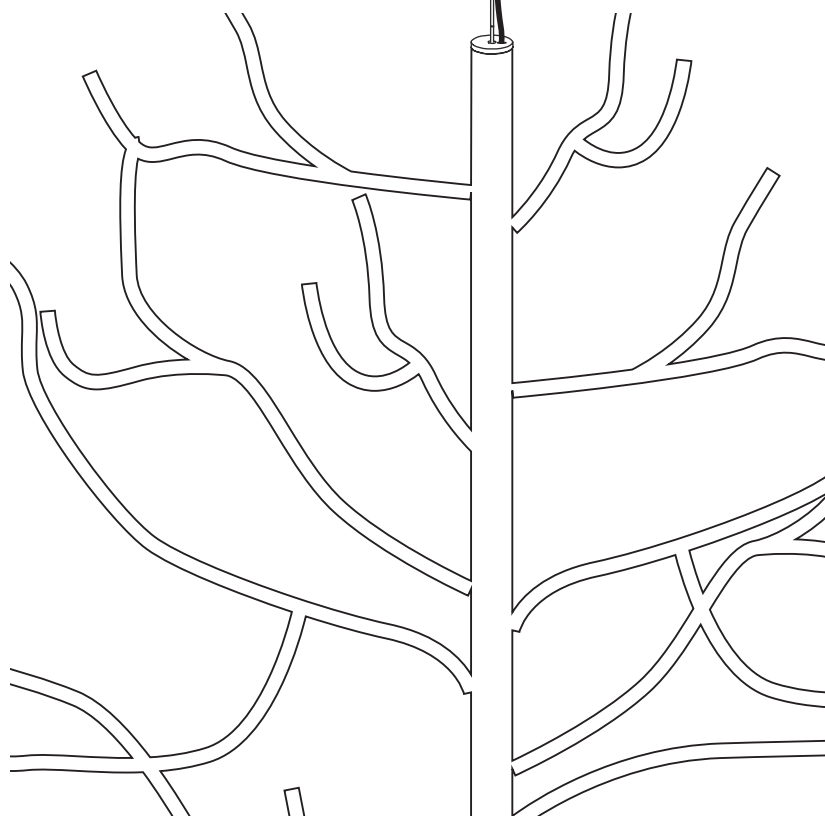
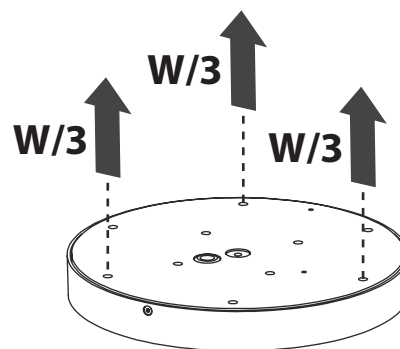

3

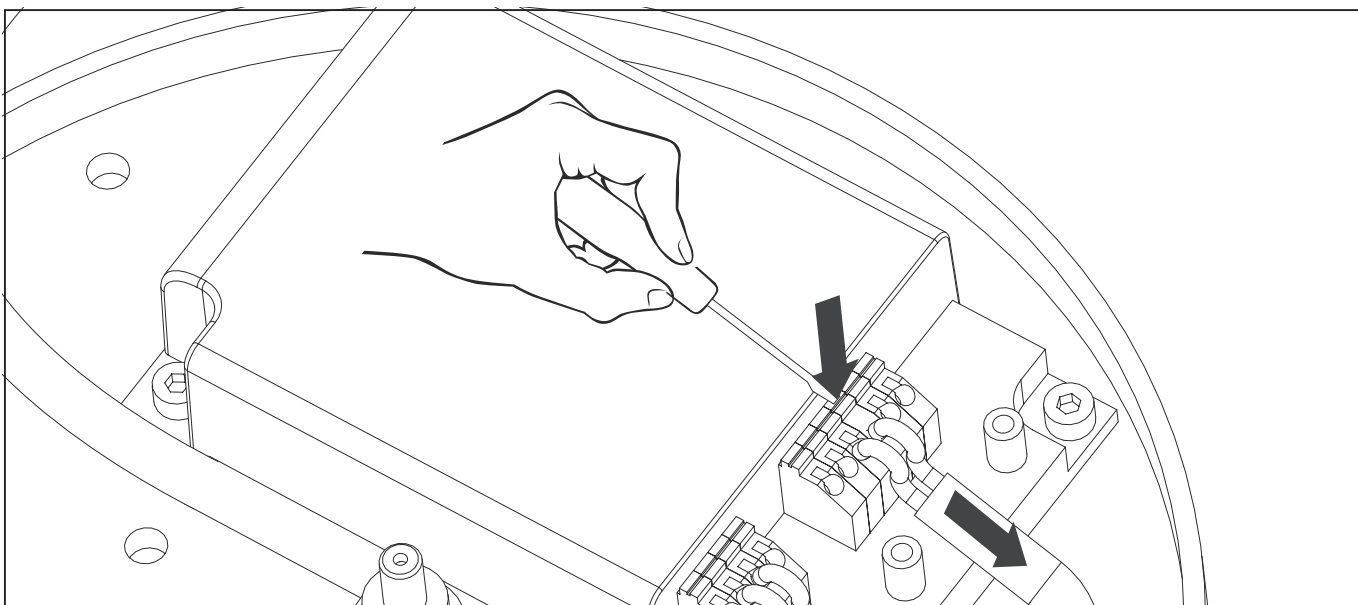
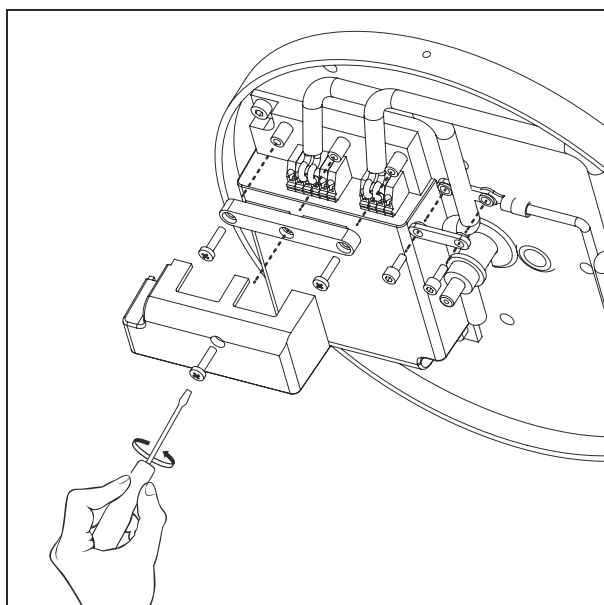
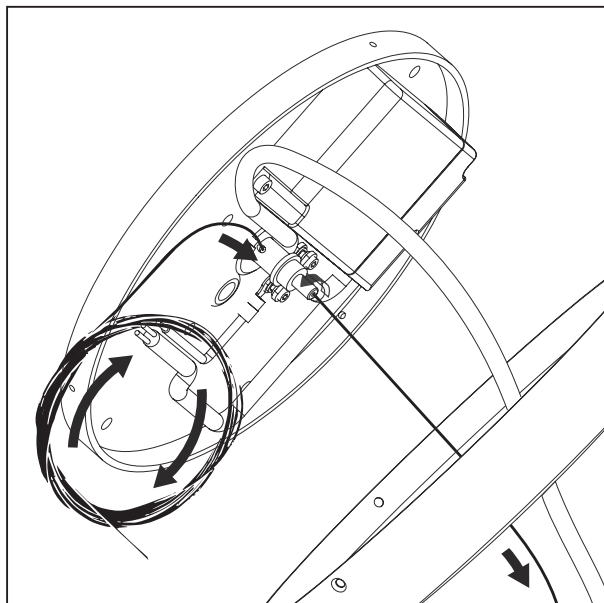
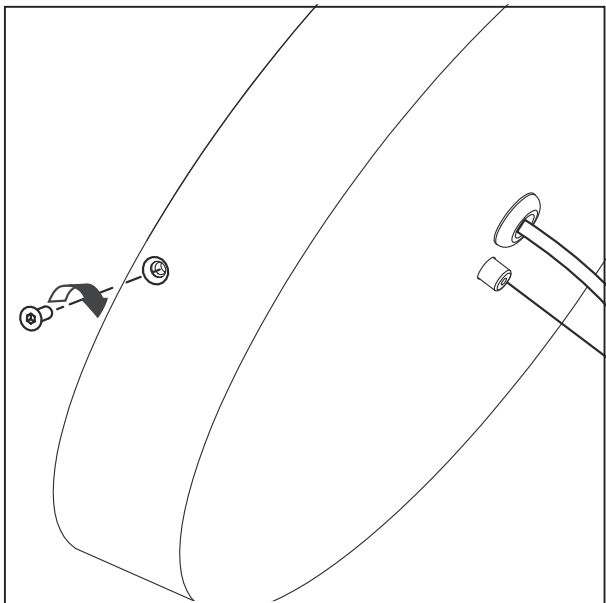

4

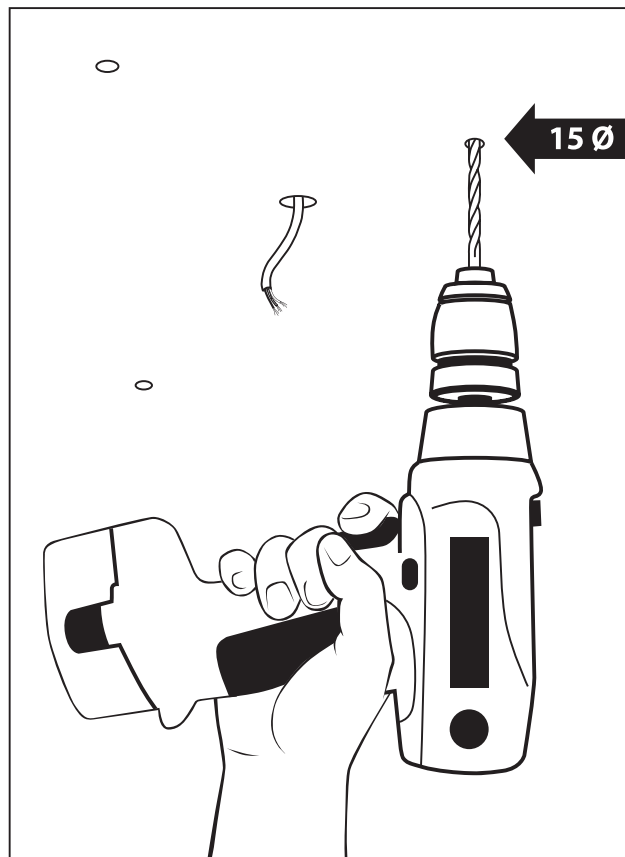
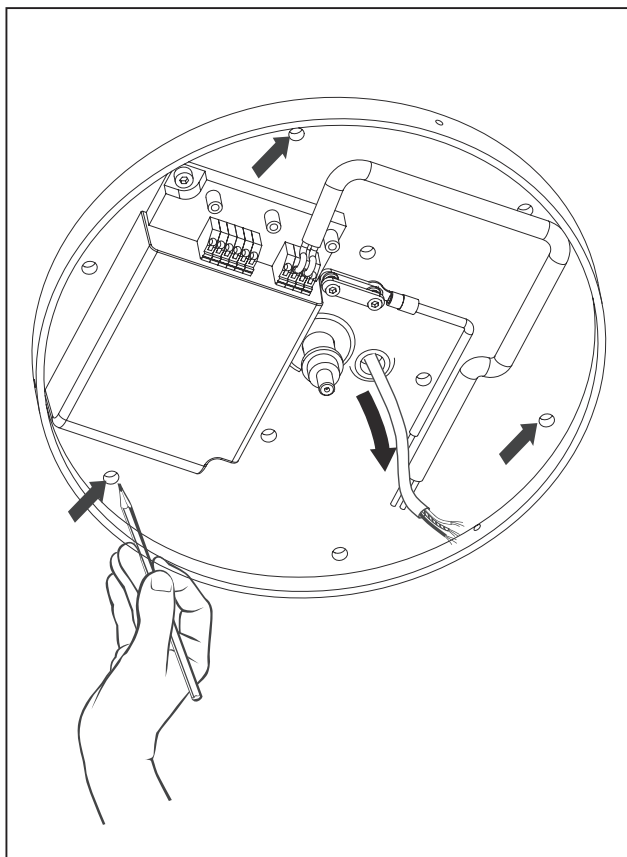

* ONLY US VERSION

* POUR US VERSION

*为 US 版本

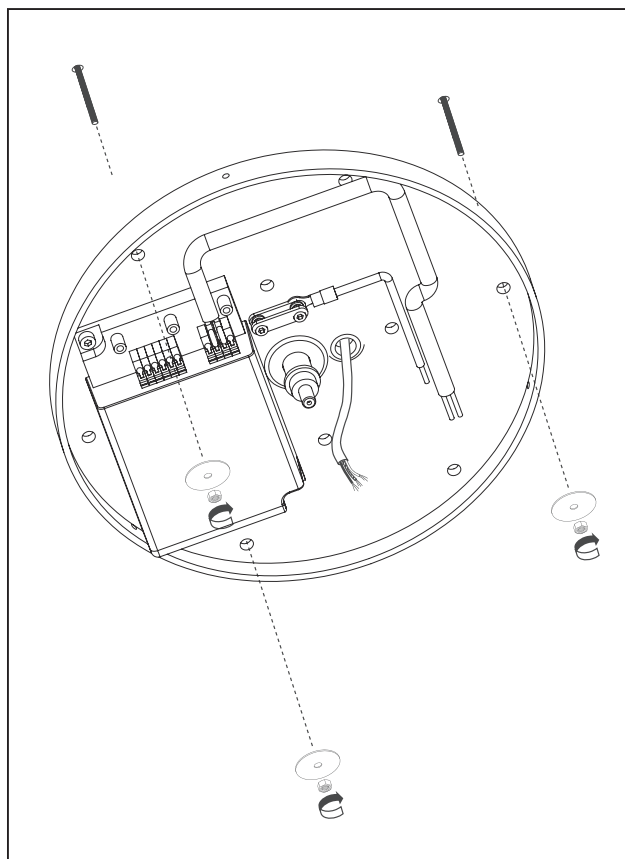
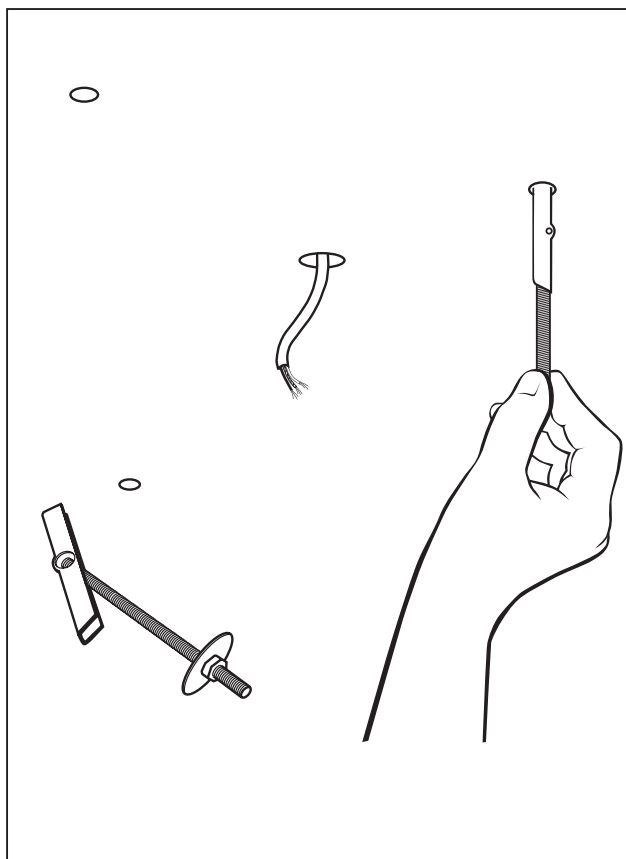

* ONLY US VERSION

* POUR US VERSION

*为 US 版本

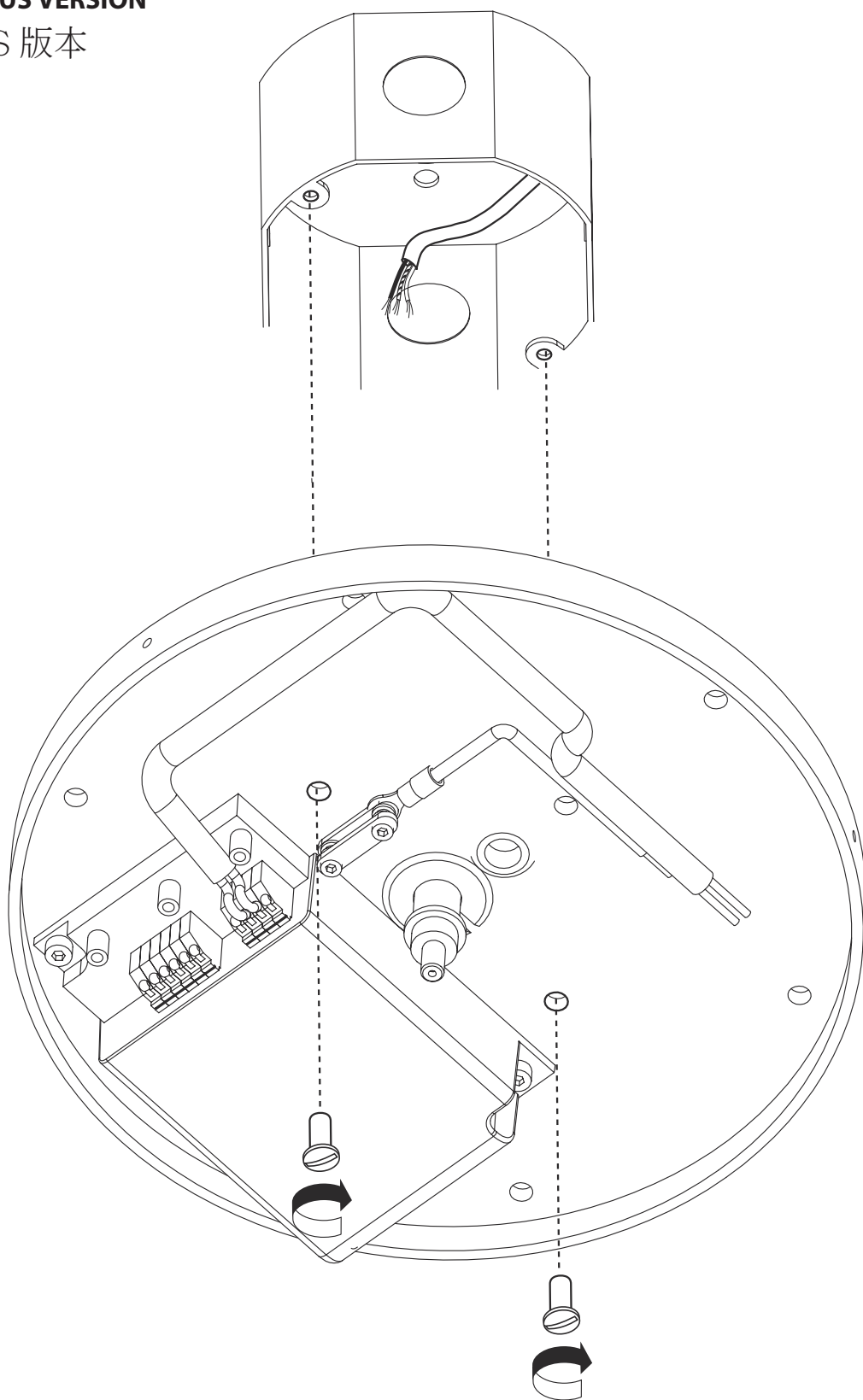

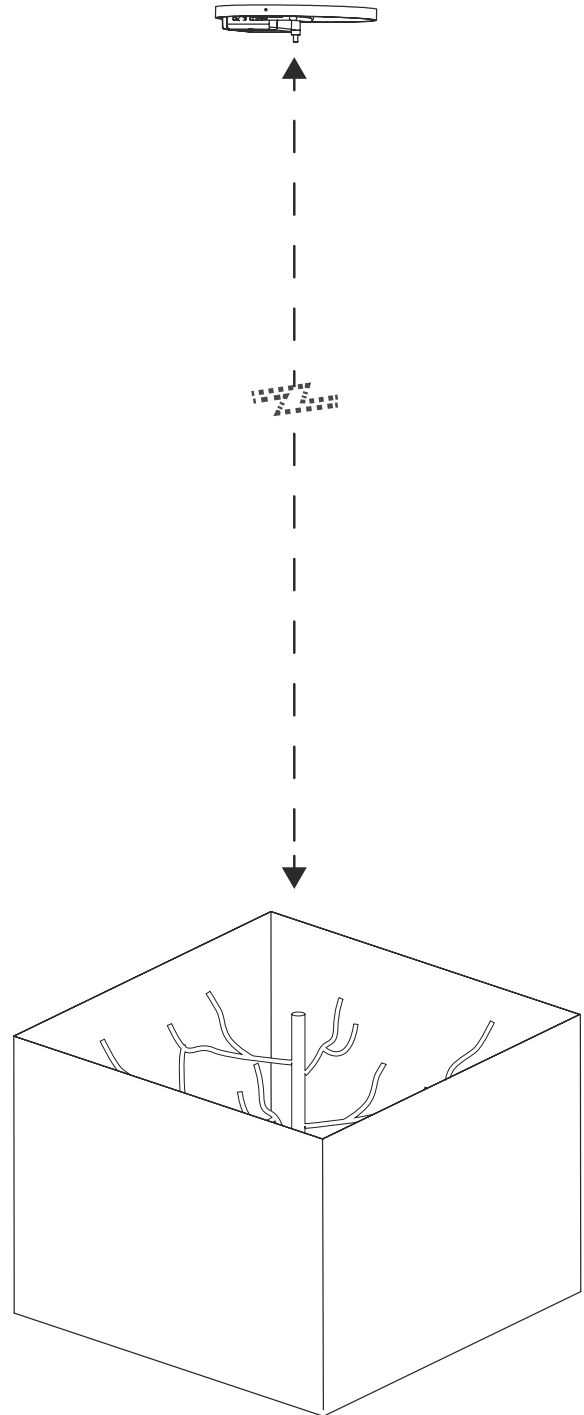
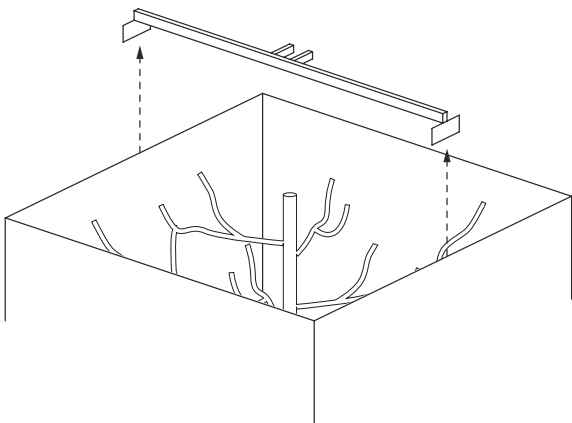
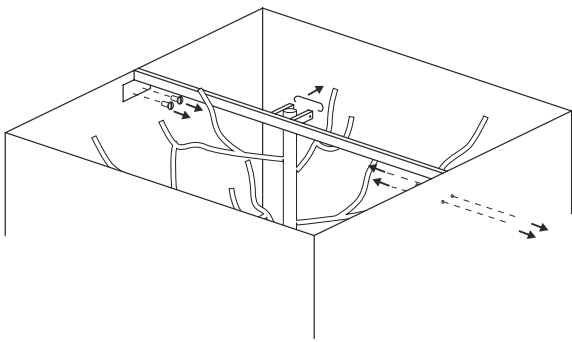

7

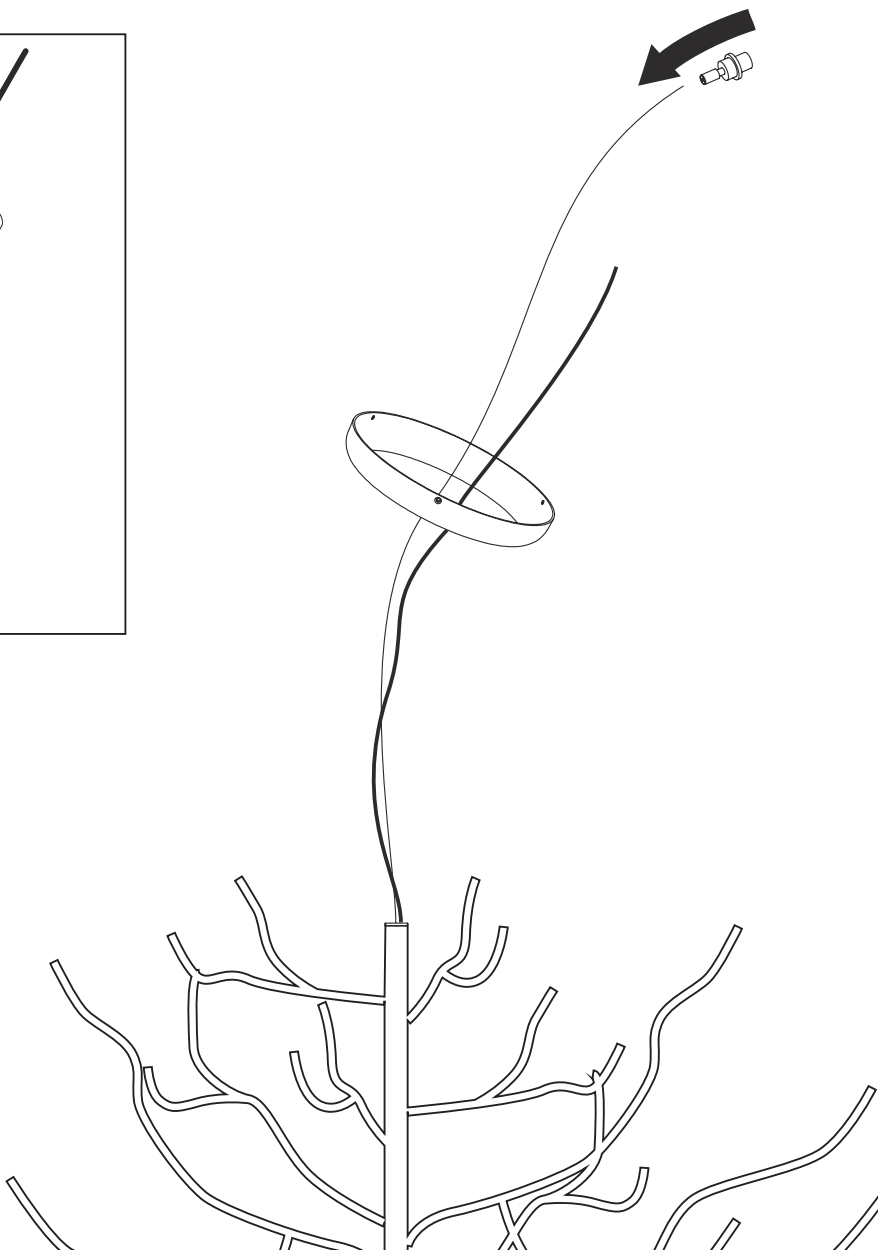
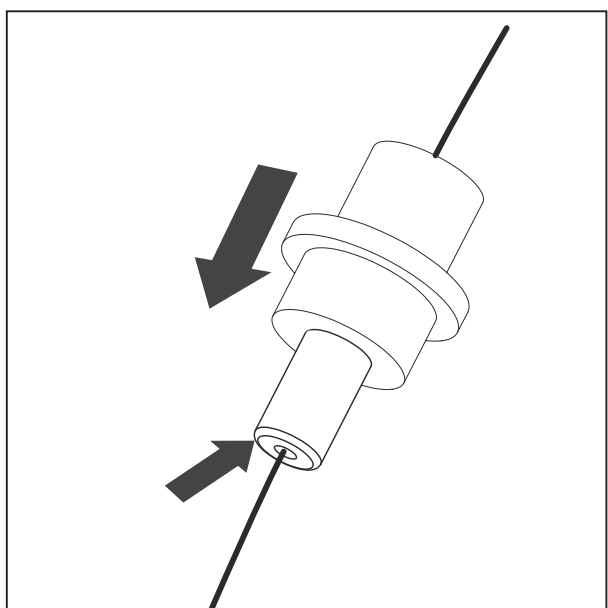
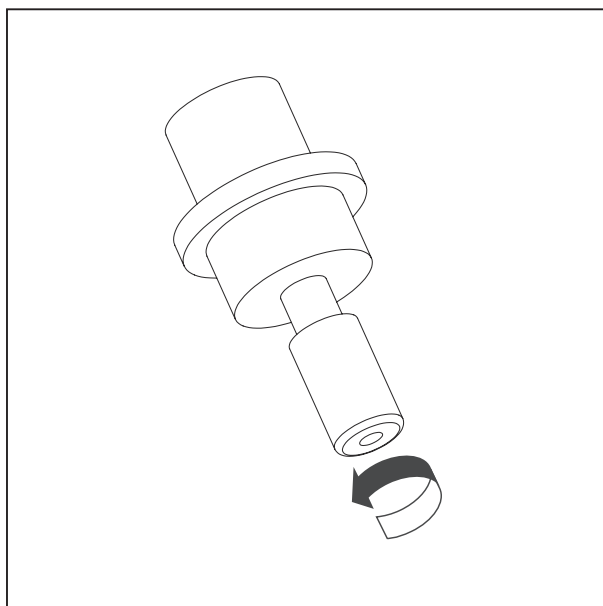
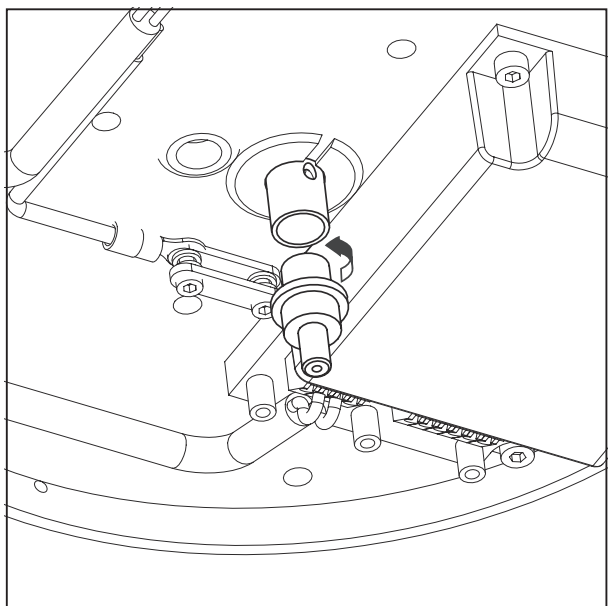



SON NECESARIAS DOS PERSONAS PARA COMPLETAR EL RESTO DE PASOS

FURTHER STEPS NEED TWO PEOPLE TO BE COMPLETED

DEUX PERSONNES SONT NÉCESSAIRES POUR COMPLÉTER LE RESTE DES ÉTAPES

进一步的步骤需要两个人完成



**NO TOCAR LAS RAMAS
DO NOT TOUCH THE BRANCHES**



NE PAS TOUCHER AUX BRANCHES

请勿触碰树枝

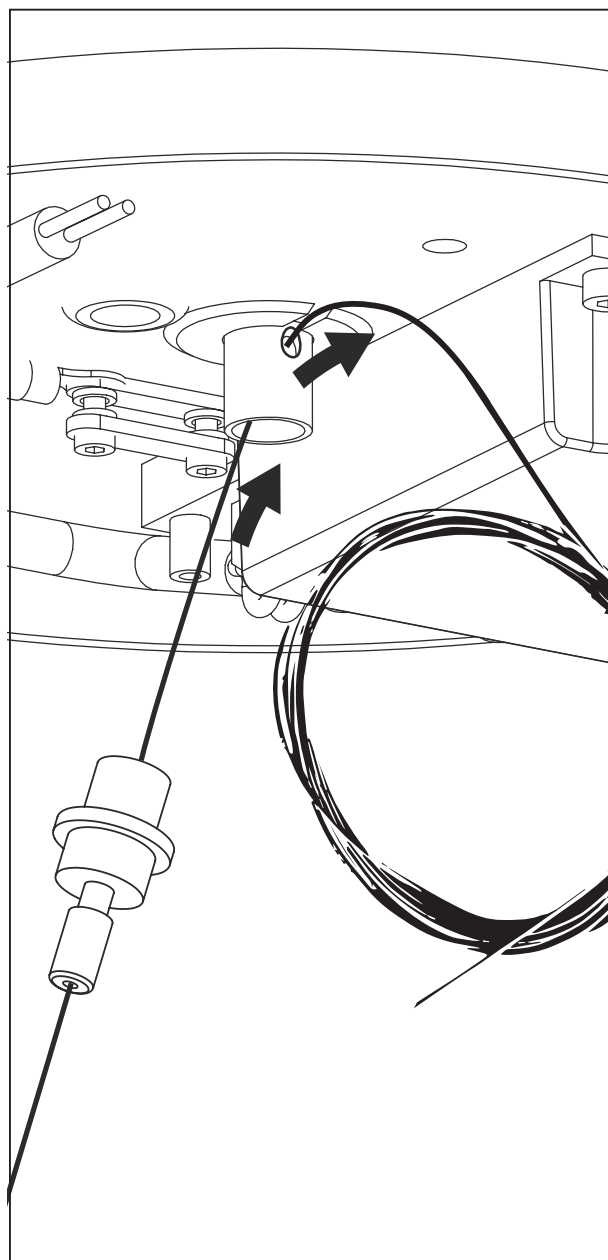
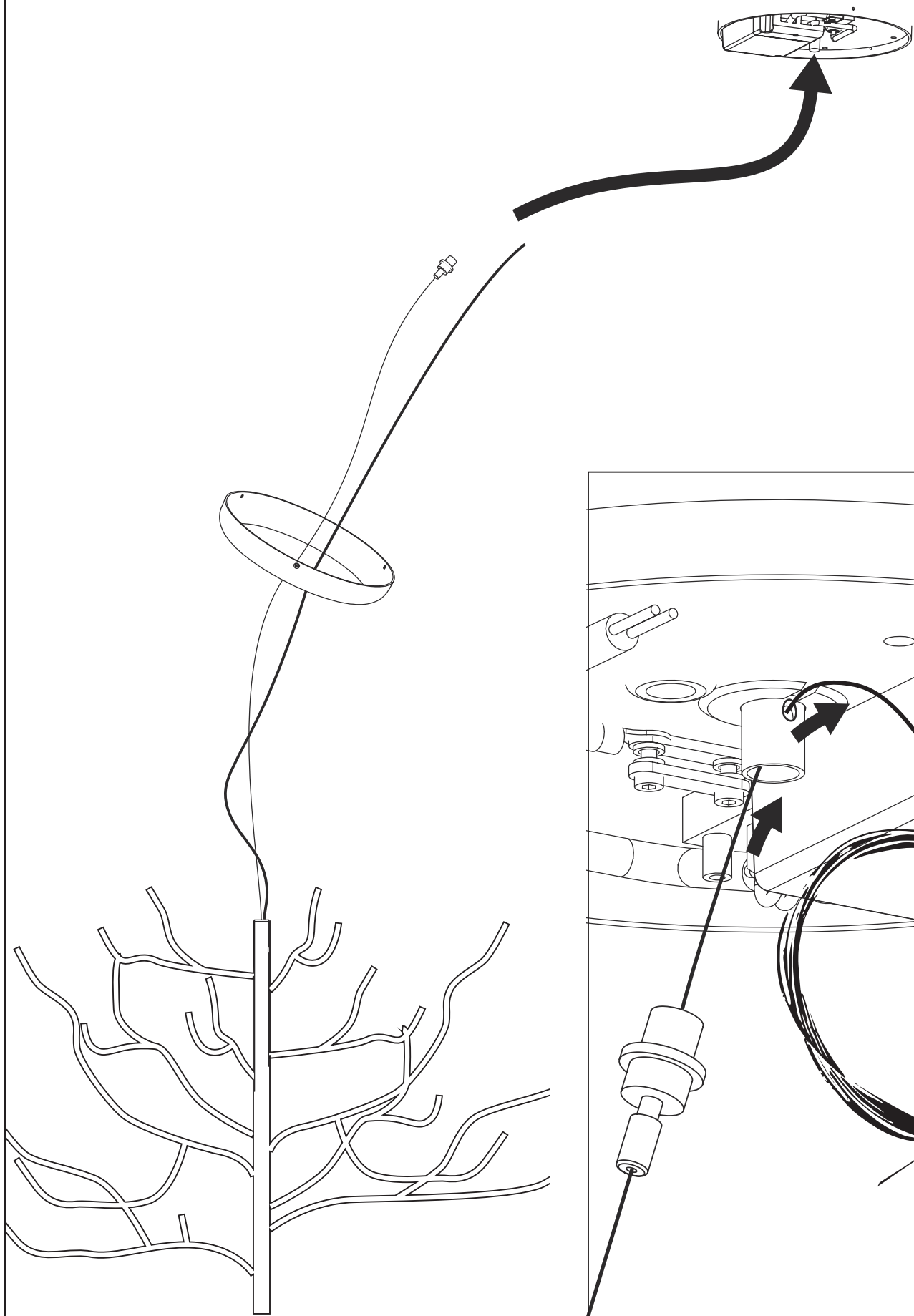

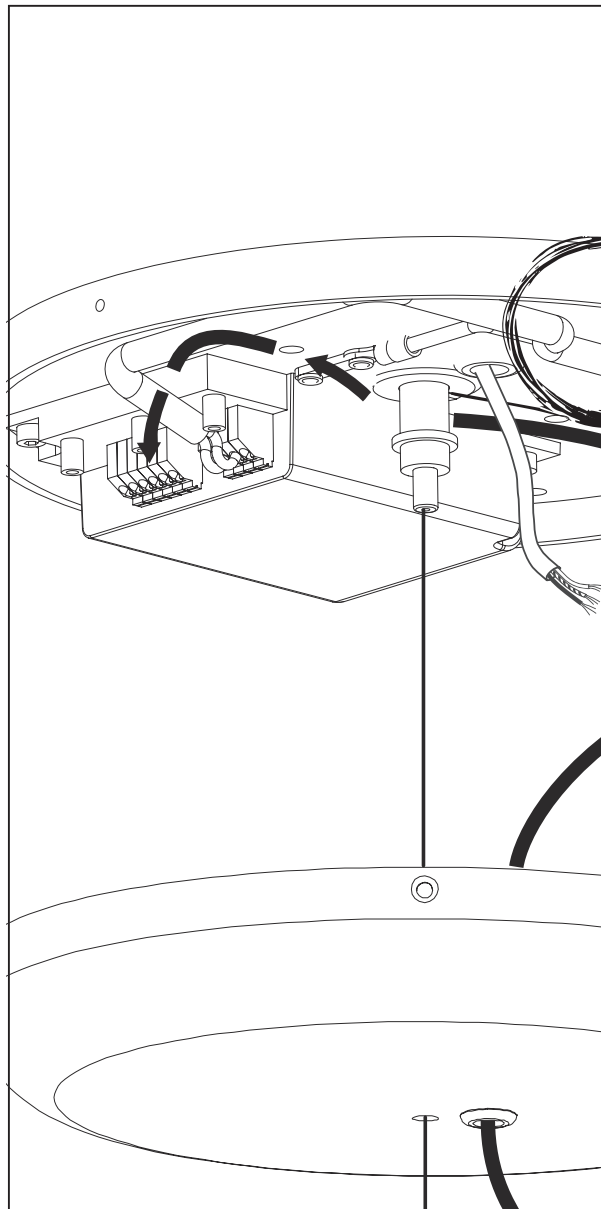
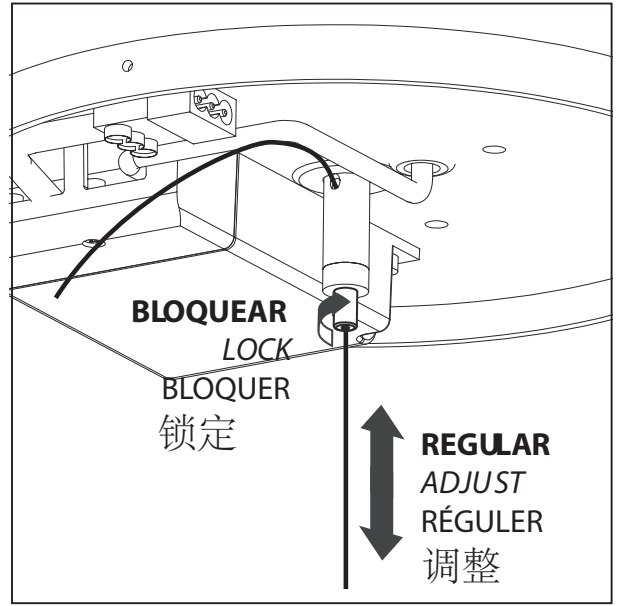
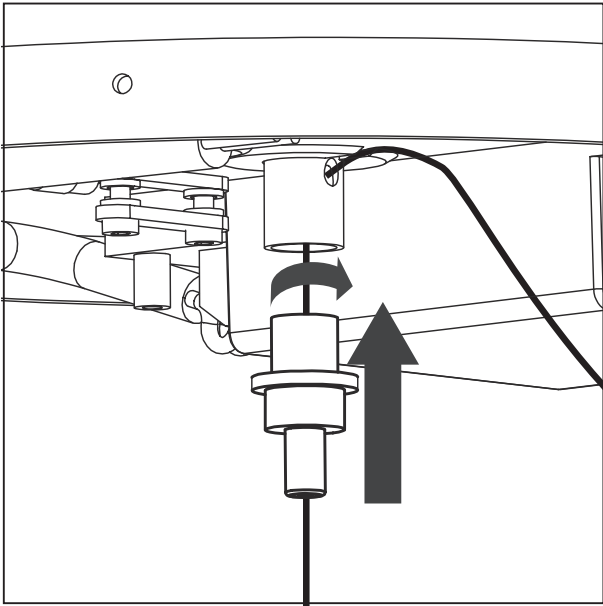

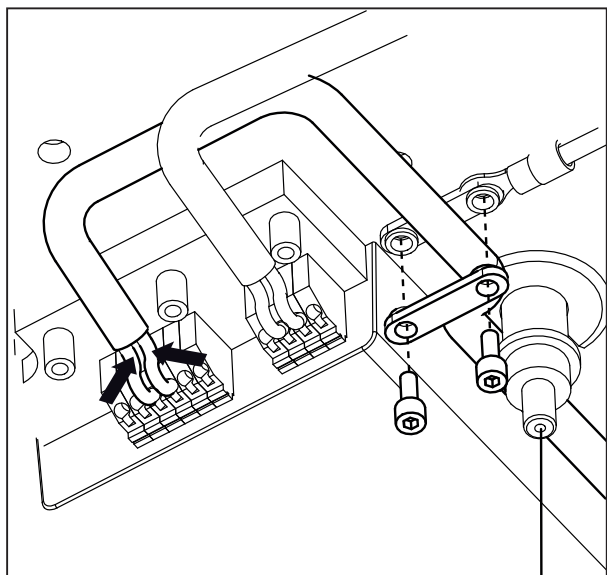

ANTES DE REALIZAR LA CONEXIÓN
BEFORE MAKING THE CONNECTION
AVANT DE FAIRE LA CONNEXION
 在进行连接之前

Utilizar dimmer regulable mediante protocolo 0-10V Additive-Sourcing.

Use dimmer adjustable by protocol 0-10V Additive-Sourcing.

Utilisez le gradateur ajustable selon le protocole 0-10V Additive-Sourcing.

使用可通过协议0-10V调节的调光器

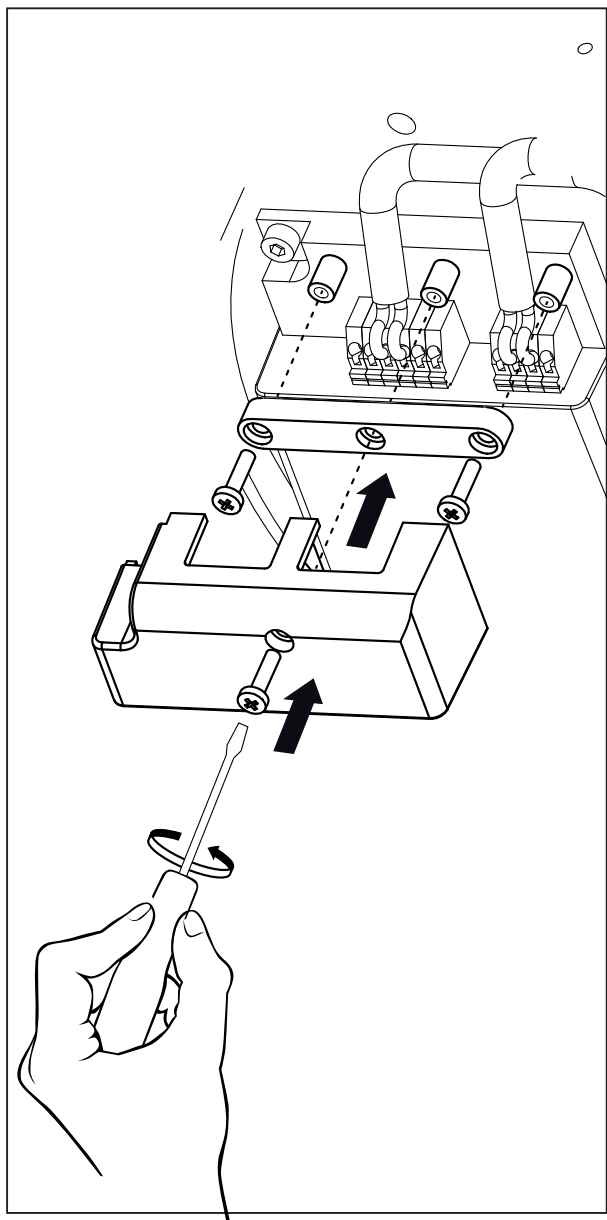

**OPCIÓN DE REGULACIÓN NO VÁLIDA
 PARA VERSIÓN US & CCC**

*DIMMER OPTION NOT AVAILAIBLE
 FOR US & CCC VERSION*

*OPTION GRADATEUR NON DISPONIBLE
 POUR LA VERSION US & CCC*

不提供调光器选项 用于US & CCC
 版本

CÓDIGOS DE COLOR
COLOR CODES
CODE DE COULEUR
 颜色代码

- **V0+**
TRANSPARENTE
CLEAR
CLAIR
 透明的
- **V0-**
NEGRO
BLACK
NOIR
 黑色

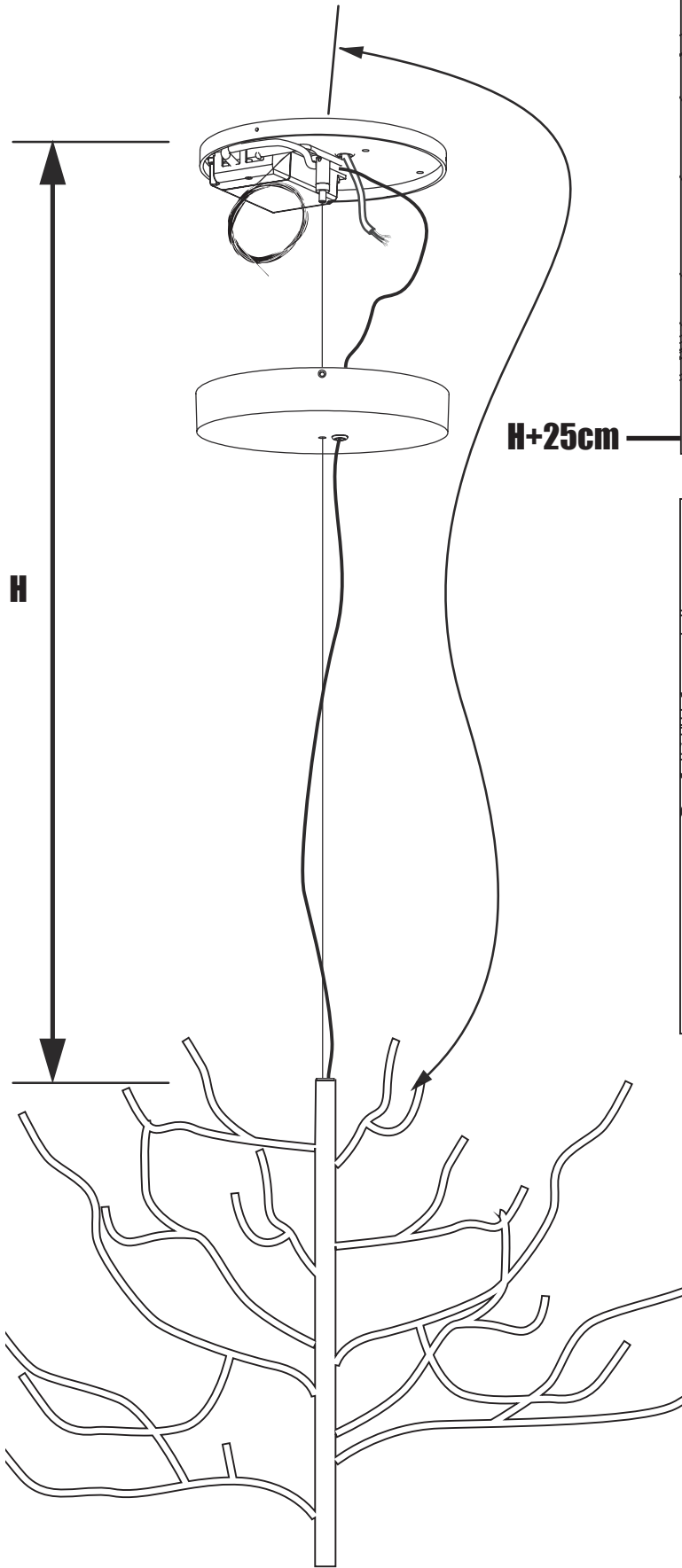

H+25cm

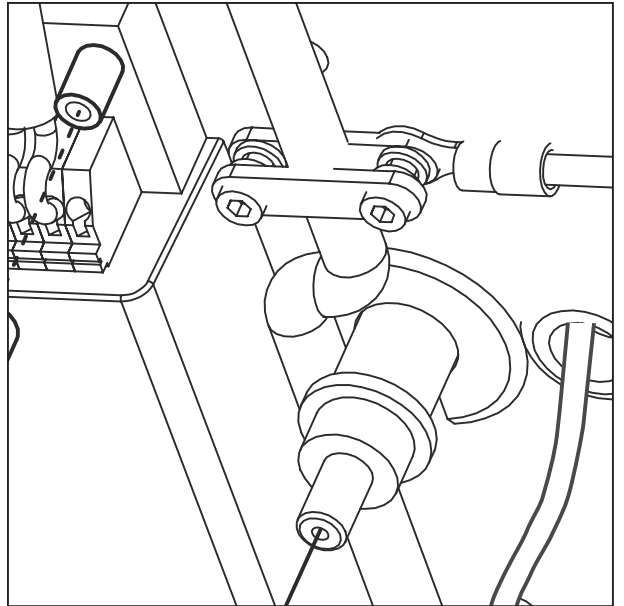
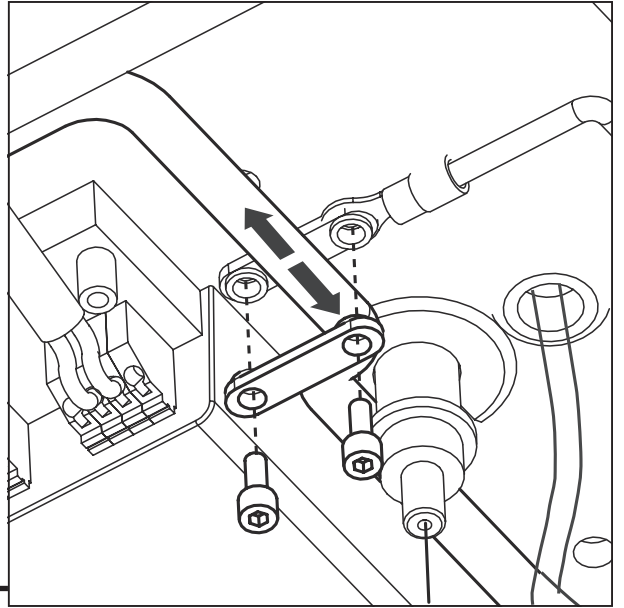

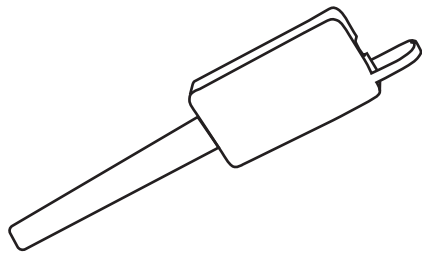

CÓDIGOS DECOLOR

COLOR CODES
CODE DE COULEUR
颜色代码

- **FASE / LINE / FASE 线 »**
NEGRO (USA), MARRÓN (EUR)
BLACK (USA), BROWN (EUR)
NOIR (USA), MARRON (EUR)
黑色 ("美国"), 棕色 ("欧洲")。
- **NEUTRO / NEUTRAL / NEUTRE »**
BLANCO (USA), AZUL (EUR)
WHITE (USA), BLUE (EUR)
BLANC (USA), BLEU (EUR)
白色 ("美国"), 蓝色 ("欧洲")。

Al cablear la fuente de alimentación a través de la caja de conexión, asegúrese de que el cableado fijo esté separado de la base de metal y la superficie de montaje mediante doble aislamiento, conéctelo a la terminal L, N como se indica.

Wiring the power source through terminal box into the terminal block, be sure that the fixed wiring separated from the metal base and mounting surface by double insulation, connect to L, N terminal as indicated.

Câblage de la source d'alimentation via la boîte à bornes dans le bornier, assurez-vous que le câblage fixe séparé de la base métallique et de la surface de montage par une double isolation, connectez à la borne L, N comme indiqué.

将电源通过接线盒接线到接线端子上，
确保固定接线与金属底座和安装面用双层绝缘隔离，
按指示连接到 L、N 端子上。

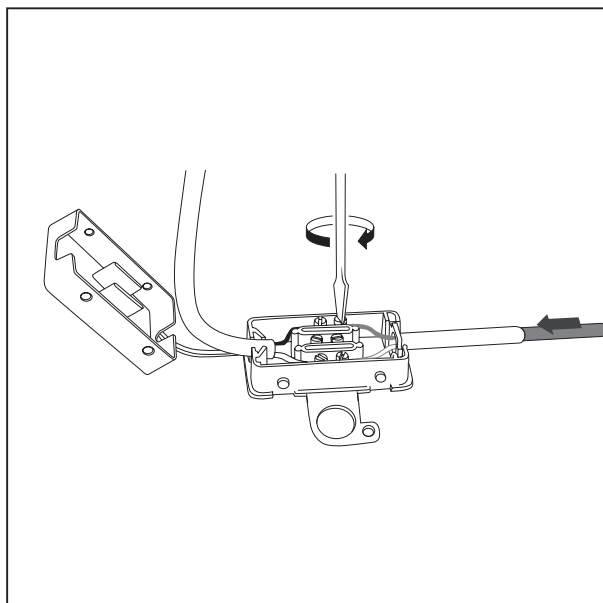
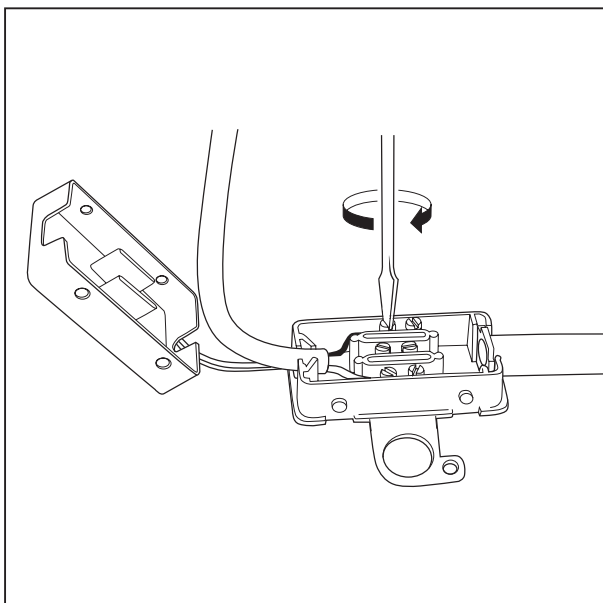
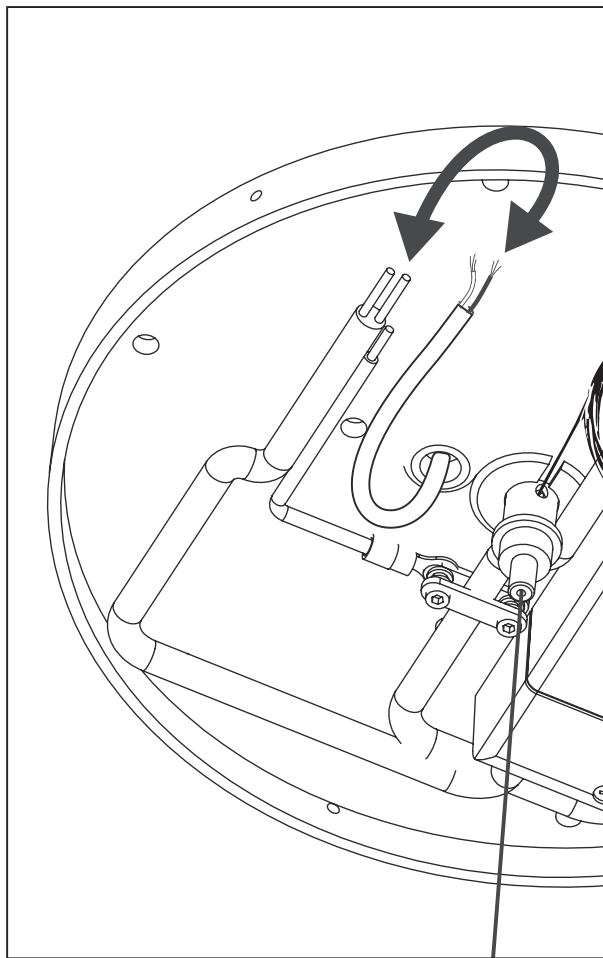

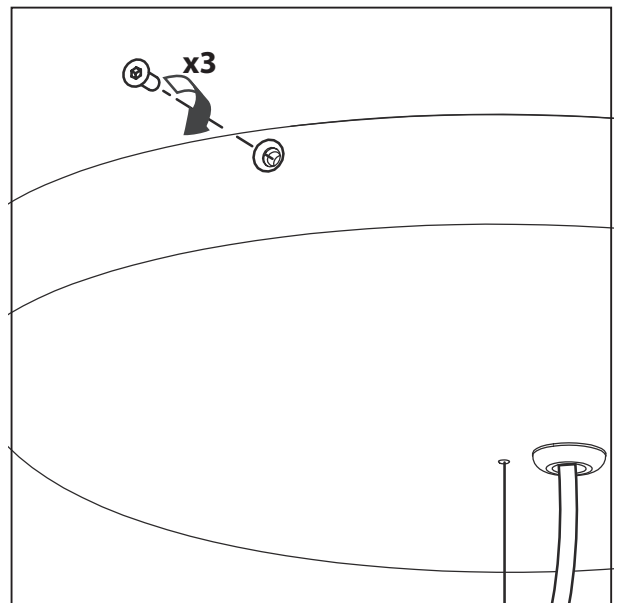
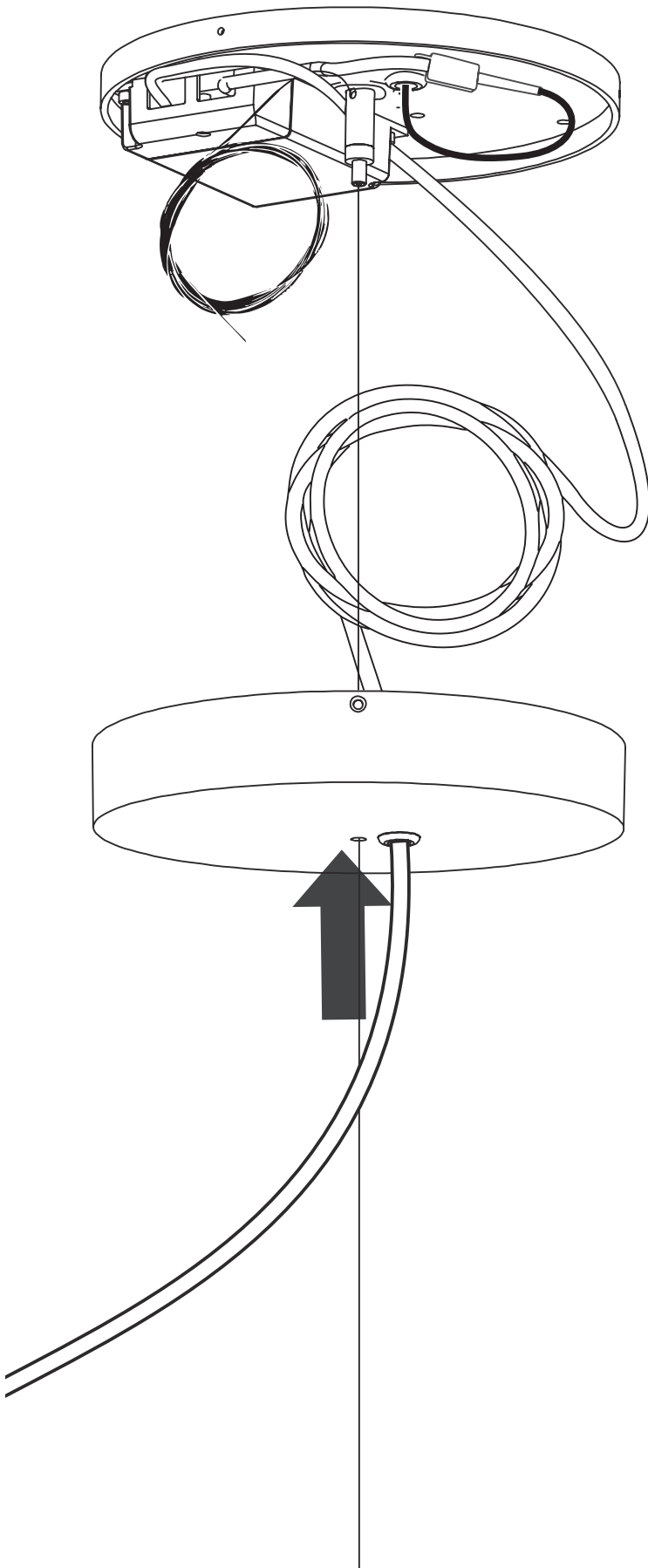

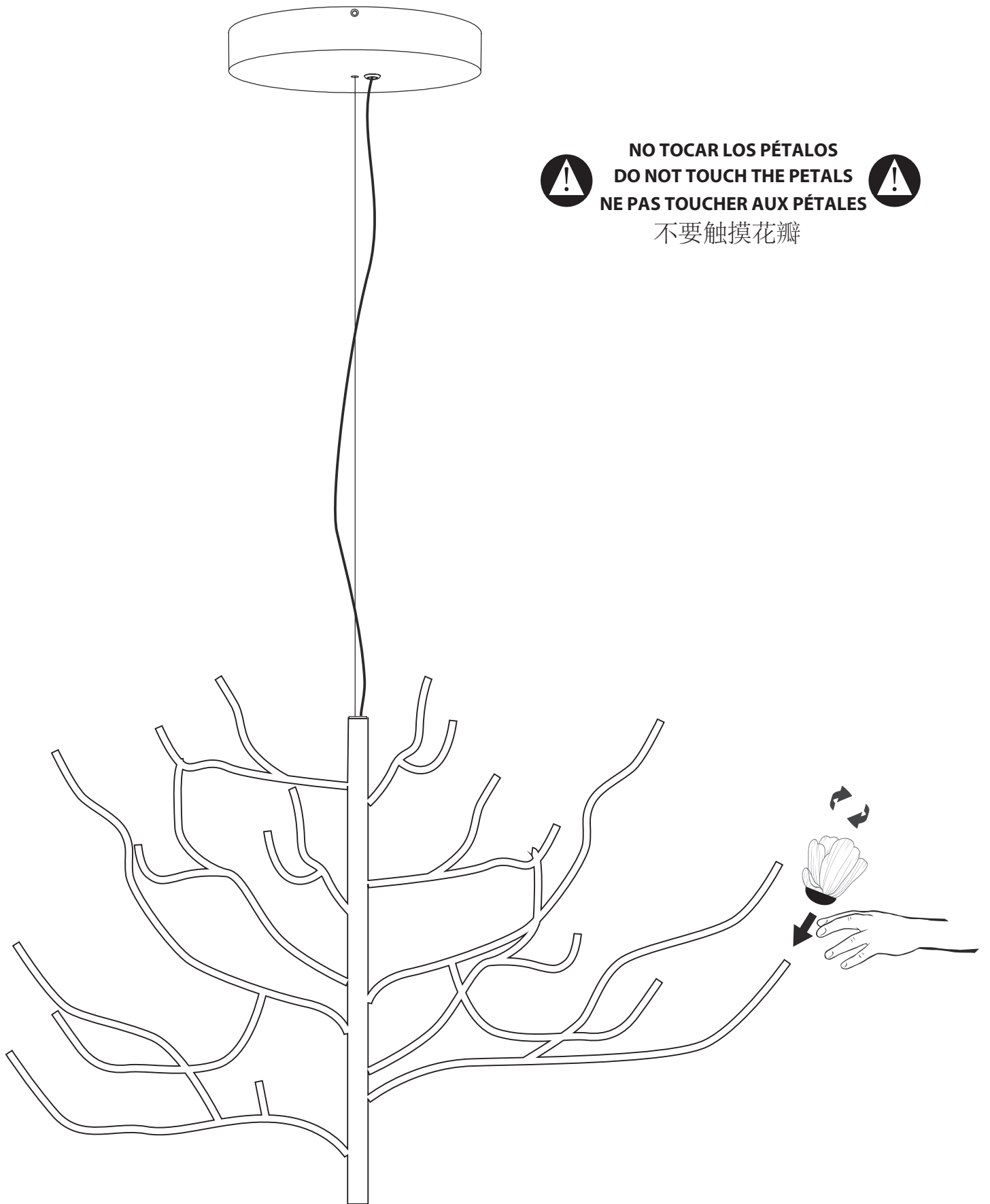

NO TOCAR LOS PÉTALOS
DO NOT TOUCH THE PETALS
NE PAS TOUCHER AUX PÉTALES



不要触摸花瓣

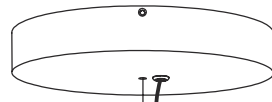

x10



x20

COLOCAR LAS FLORES CON MÁS PÉTALOS EN LA PARTE INFERIOR
FIT THE FLOWERS WITH MORE PETALS IN THE BOTTOM PART
PLACEZ LES FLEURS AVEC PLUS DE PÉTALES EN BAS

用更多的花瓣装在底部的花中。

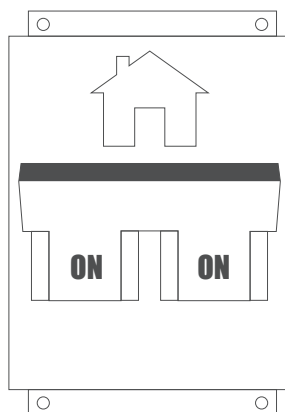
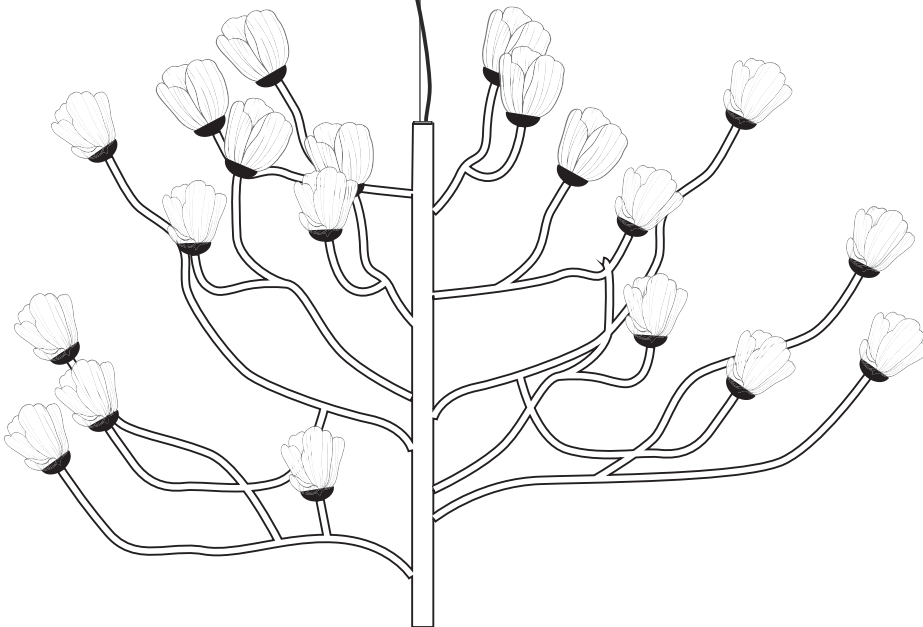



Mokuren chandelier



REF. 01024261 - (CCC)
REF. 01024260 - (JP)
REF. 01024259 - (US)
REF. 01024258 - (CE/UK)



LLADRÓ

HANDMADE PORCELAIN
Spain

LLADRÓ - VALENCIA, SPAIN
(+34) 963 187 000
(+34) 900 211 010 (TOLL FREE)
customer-services@es.lladro.com
www.lladro.com