



BROKIS®



CM12097

BONBORI

PC1165



Download

COMPONENTS INCLUDED WITH UNIT:

- 1× lamp body
- 1× upper section
- 1× cap
- 1× light source
- 1× glass shade
- 1× glass diffuser
- 3× set screws M6×16
- 3× hex screws M6×25
- 1× set screw M4×4
- 1× power cable with connector
- 1× hex key size 1.5
- 1× hex key size 2
- 1× pair cotton gloves
- 1× installation manual

Installation time: 30 minutes / 1 person

WARNING:

The manufacturer assumes no liability for damage resulting from incorrect assembly.

When unpacking the light, do so with regard for its material composition – the main components are made of glass.

Wear the cotton gloves included with the light when unpacking and assembling it.

IF THE EXTERNAL FLEXIBLE CABLE OF THIS LIGHT IS DAMAGED, FOR SAFETY REASONS IT MUST ONLY BE REPLACED BY THE MANUFACTURER, A TECHNICIAN AUTHORIZED BY THE MANUFACTURER, OR A PERSON WITH THE SAME QUALIFICATIONS.



BROKIS®

BROKIS S.R.O.
ŠPANELOVA 1315/25
163 00 PRAHA 6 - ŘEPY
CZECH REPUBLIC

ORG. ID 64940799
VAT ID CZ64940799
C 42174 MĚSTSKÝ SOUD
V PRAZE

TEL +420 567 211 517
TECHNICAL@BROKIS.CZ
INFO@BROKIS.CZ
WWW.BROKIS.CZ



CLEANING THE GLASS

BROKIS upholds only the highest possible quality standards. Prior to shipping, the light undergoes several quality controls and stages of cleaning. Because transportation, storage, and the amount of time that passes between packing at our plant and subsequent unpacking by the client can affect the light in different ways, we strongly recommend cleaning it prior to assembly.

The glass must first be rinsed in warm water, and a dish detergent may be used to remove all foreign particles, dust, and grease. Repeat the process if necessary and then dry the glass thoroughly with a paper towel.

Recommendation: Do not use mineral spirits, highly concentrated thinners, or other substances not intended for use on glass surfaces. Do not use any cleaning agents containing silicone, as they may leave a film and attract dust and smudges.

PRIOR TO SHIPPING, THE FUNCTIONALITY OF EACH LIGHT AND ITS COMPONENTS IS THOROUGHLY TESTED. THE MANUFACTURER ASSUMES NO LIABILITY FOR THE MISHANDLING OF PRODUCTS.



1. ASSEMBLING THE LIGHT

Screw the light source into the fixture.

Insert the diffuser into the top of the body. When doing so, hold the body at an angle to prevent damage to the diffuser, then return it to a vertical position. Insert the diffuser into the light through the open side!

Turn the 3 set screws (M6×16) from the inside of the body so that they are flush with the outer surface of the light.

Position the upper section on the set screws (M6×16) and turn it to secure the bayonet.

Tighten the set screw (M4×4) at the top of the body to prevent the upper section from turning.

Position the glass shade on the body with the larger opening facing downwards and install 3 set screws (M6×25) into the holes in the upper section.

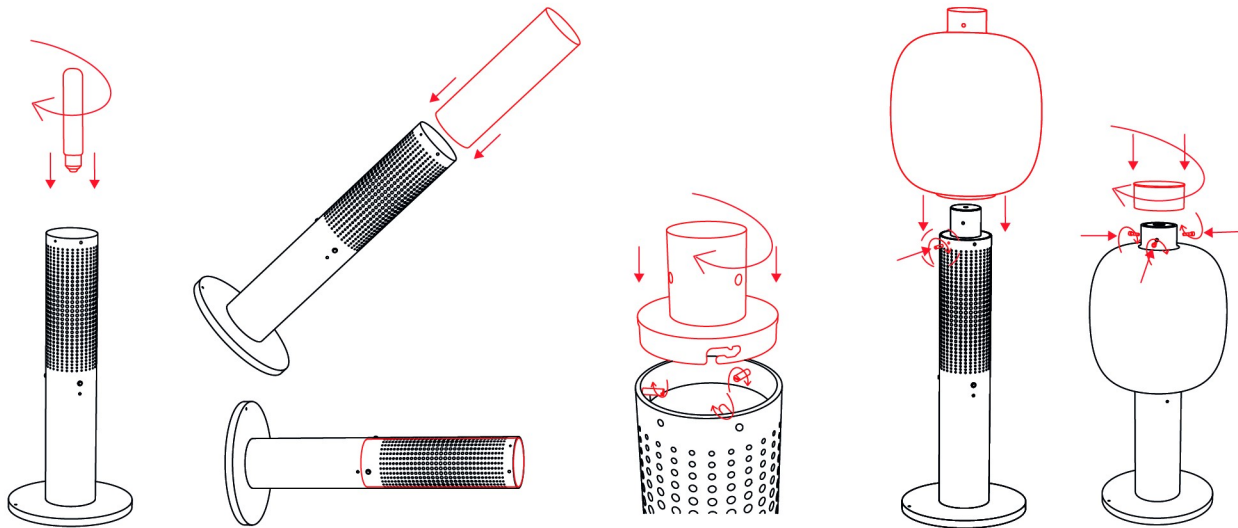

2. CONNECTING THE LIGHT

Loosen the set screw (M3×3) on the power cable connector. Insert the cable connector into the connector on the light and turn the sleeve to close. Retighten the set screw in the connector.

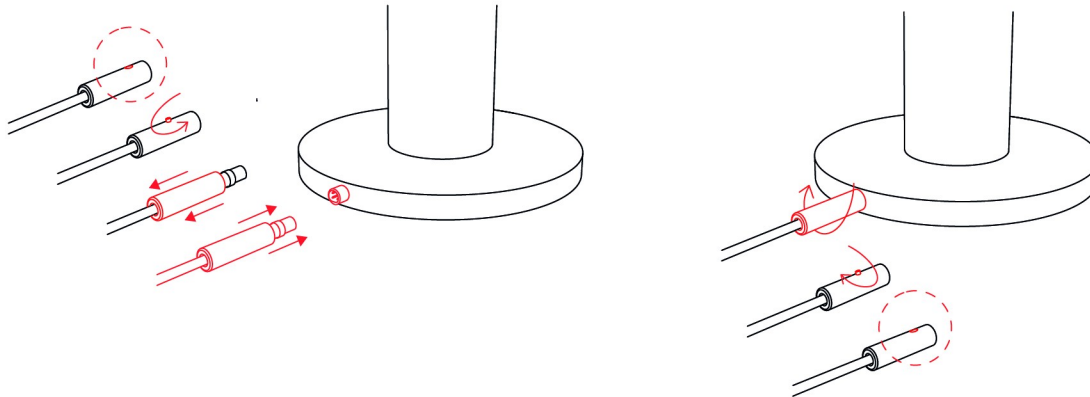

3. SWITCHING ON THE LIGHT

Plug the power cable into an electrical outlet and verify that the light works properly.

