

ATOMOS PENDANT

INSTALLATION INSTRUCTIONS

1 OF 6

BARONCELLI ⌘

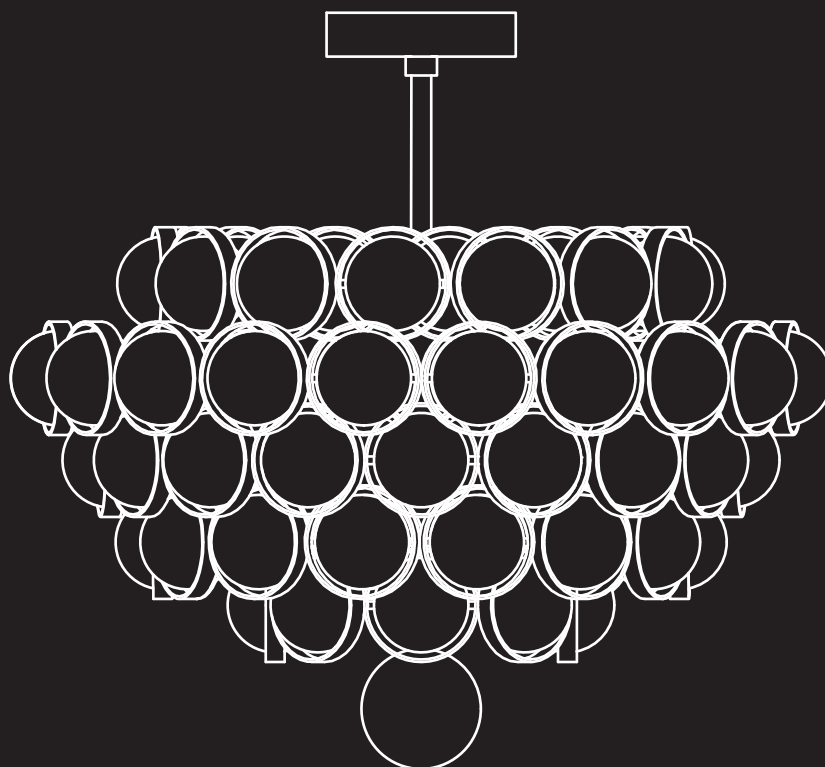

WHAT IS INCLUDED

1. Ceiling canopy
2. Frame
3. Glass
2. Spares
3. Chandelier pins

WHAT YOU WILL NEED

1. Screws
2. Bulbs: E12 (120V) / E14 (240V) Golf (max 60w)
3. Screwdriver (3.5mm / 1/8" flat tip) + pliers
4. Soft cloth
5. Allen Keys

WEIGHTS

4 Lights 15kg (33LB)

ATOMOS PENDANT INSTALLATION INSTRUCTIONS 2 OF 6

BARONCELLI ⌘

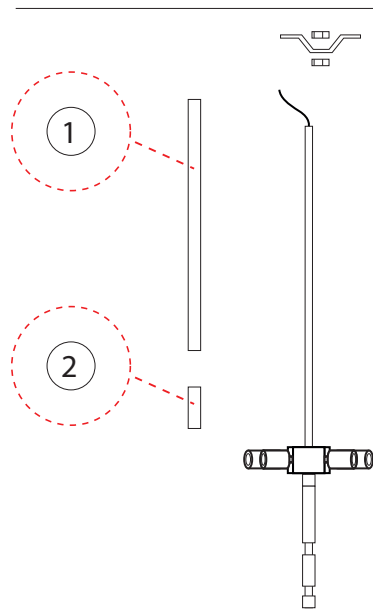

STEP 1

Stand the stem upwards and remove bracket bar, stem 1 and 2.

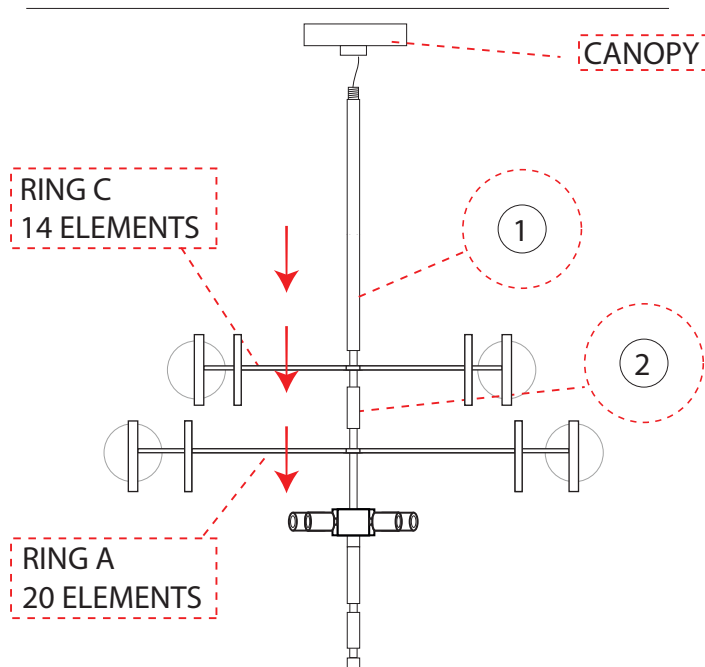

STEP 2

Add stem elements to the top side of the stem in the order shown above.

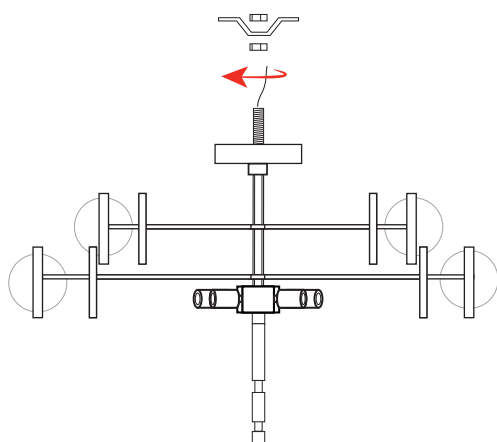

STEP 3

Pass the stem through the bracket bar and secure using nuts.

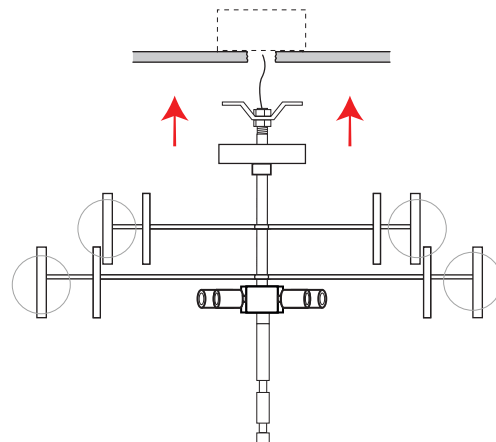

STEP 4

Securely fasten bracket bar into ceiling beam or joist (Junction box for US). Ensure the fixings are capable of taking a relevant load. See APPENDIX for bracket sizing.

ATOMOS PENDANT

INSTALLATION INSTRUCTIONS

3 OF 6

BARONCELLI ⌘

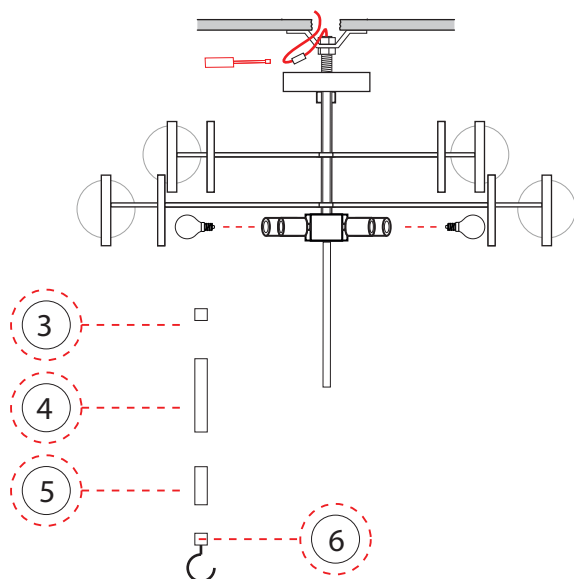

STEP 5

Make electrical connections. Insert bulb and test and raise canopy. Remove stem element 3, 4, 5 and 6.

NOTE: 120V REQUIRE E12 AND 240V REQUIRE E14 (MAX 60W)

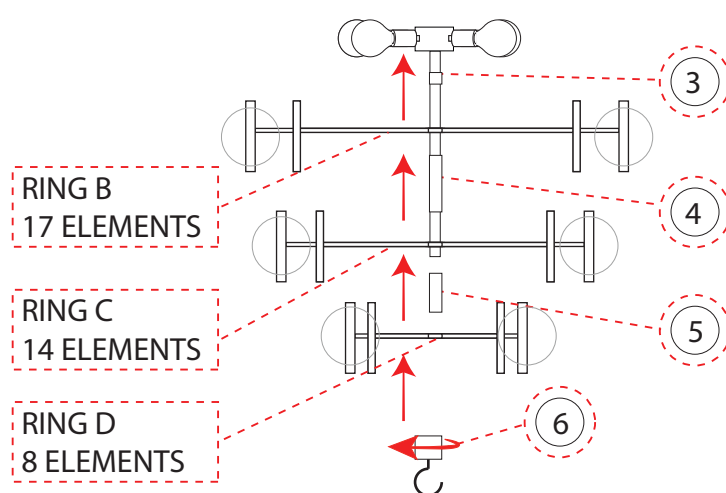

STEP 6

Assemble lower stem elements in the shown above.

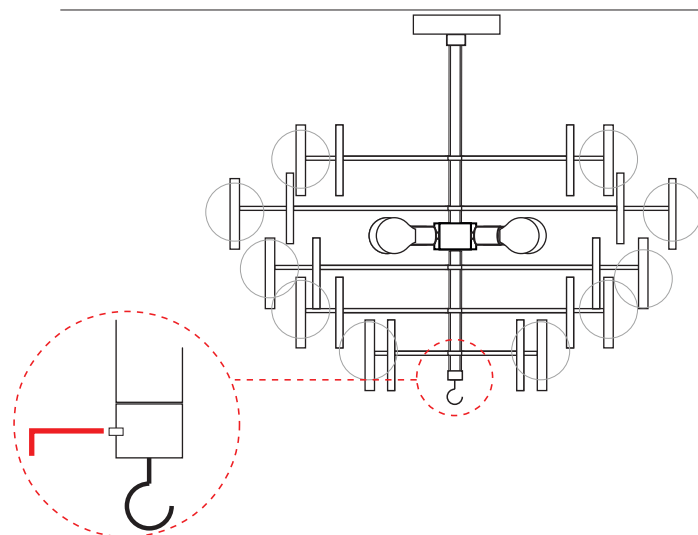

STEP 7

Attach the stem element L and ensure this is secured in place by using the grub screw attachment.

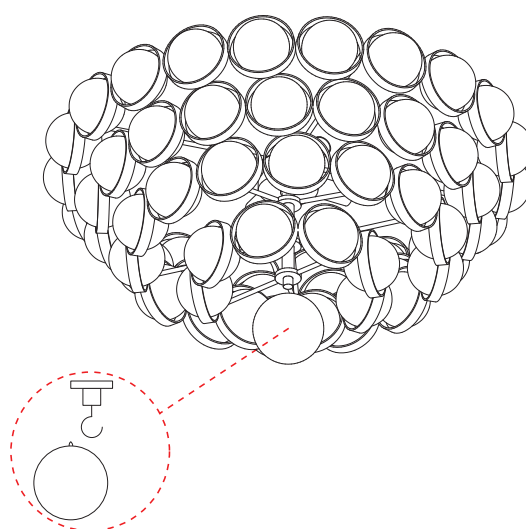

STEP 8

Hang larger glass sphere to the end of the stem.

ENSURE ANY ELECTRICAL WORK IS CARRIED OUT BY A QUALIFIED ELECTRICIAN

OPERATION AND MAINTENANCE

4 OF 6

BARONCELLI ⌘

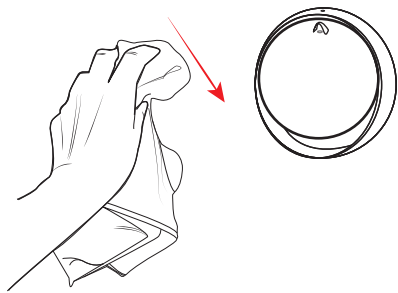

GLASS CLEANING

Glass elements should be carefully cleaned using a soft cloth.

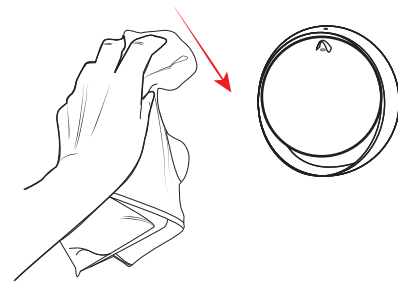

METAL CLEANING

Carefully clean metal surfaces using a soft cloth and no liquid.

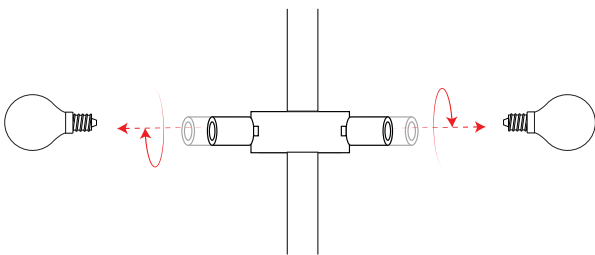

REPLACING A BULB

Ensure electricals are switched off and bulb has cooled down. Unscrew bulb and replace. Remove glass if required to access.

NOTE: 120V REQUIRE E12 AND 240V REQUIRE E14 (MAX 60W)

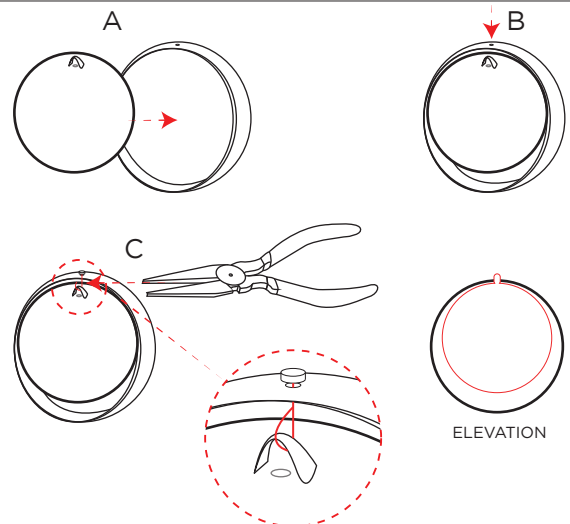

REPLACING GLASS

Insert the pin into the metal ring. Using pliers, bend the pin through the glass hoop and back round so it is hanging securely. Ensure ball hangs at the top of ring.

ENSURE ANY ELECTRICAL WORK IS CARRIED OUT BY A QUALIFIED ELECTRICIAN

OPERATION AND MAINTENANCE

5 OF 6

BARONCELLI

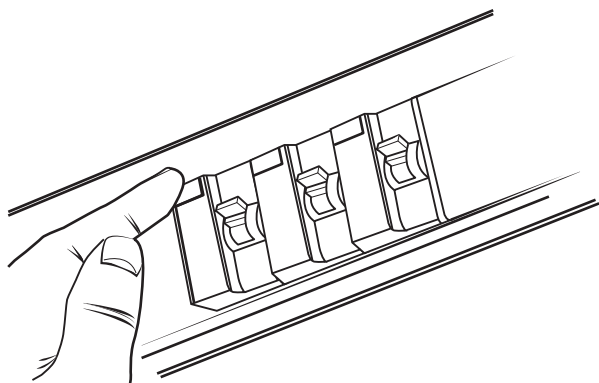

STEP A
TROUBLE SHOOTING - ELECTRICAL FAULTS
Check fusebaord

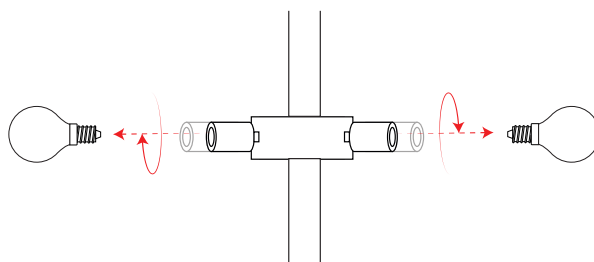

STEP B
TROUBLE SHOOTING - ELECTRICAL FAULTS
Check and replace the bulbs.

NOTE: 120V REQUIRE E12 AND 240V REQUIRE E14 (MAX 60W)

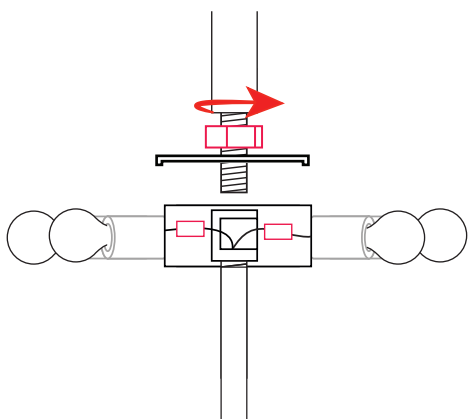

TROUBLE SHOOTING - ELECTRICAL FAULTS
Retrace installation steps to release all the elements.
Check/test lighting unit & lamp holder.

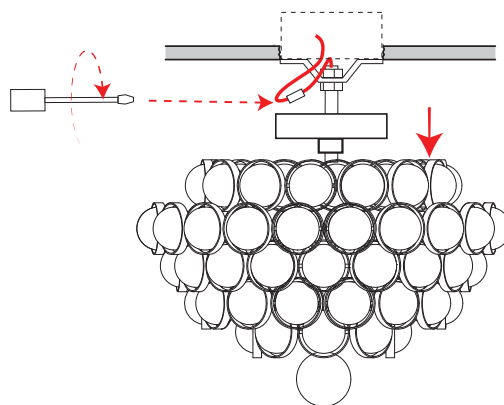

STEP D
TROUBLE SHOOTING - ELECTRICAL FAULTS
Lower ceiling canopy. Check/test connections.

ENSURE ANY ELECTRICAL WORK IS CARRIED OUT BY A QUALIFIED ELECTRICIAN

APPENDIX

6 OF 6

BARONCELLI ⌘

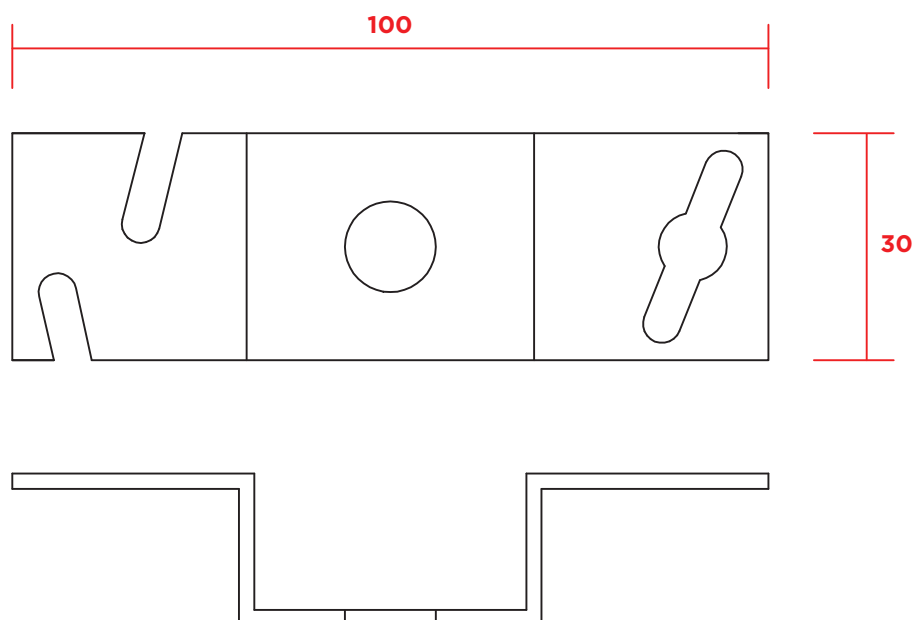

CEILING FIXING BRACKET

Bracket supplied sized as above.

SCALE 1:1 @ A4