

# dark & bright star

Design by Dechem Studio

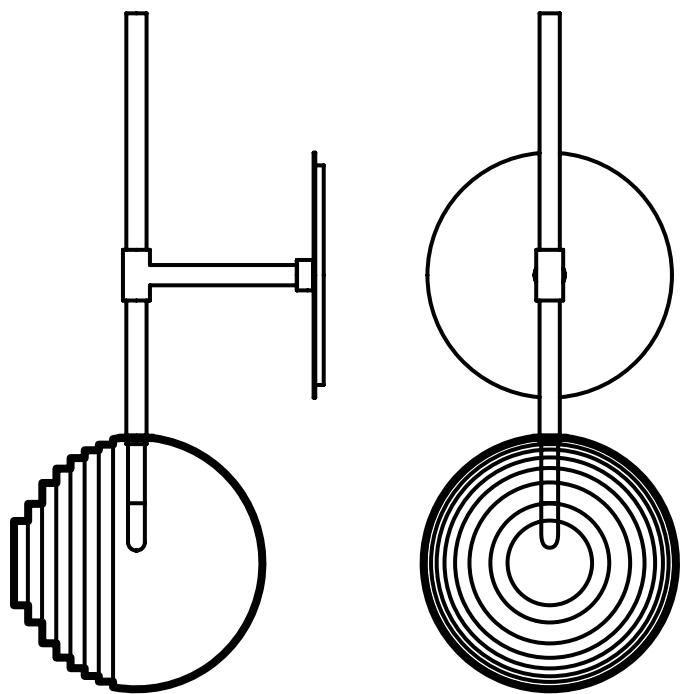

bomma

bomma.cz

TECHNICAL SHEET  
FOR WALL LIGHT FIXTURES

# DARK & BRIGHT STAR

## wall large

Design by  
Dechem Studio

### Handmade glass attributes

All Bomma products are hand-made from mouth-blown lead-free crystal. Therefore any small bubbles and/or irregularities in the glass are both a proof and a characteristic feature of this traditional craft.

The Dark and Bright Star Collection is produced in two colors, simply referred to as dark and bright. The bright version is clear glass with an opaque sanded finish, the dark version is made of fully-colored glass. Thanks to the manual process of blowing, each piece is an original. Individual products may vary slightly in hue or color intensity.

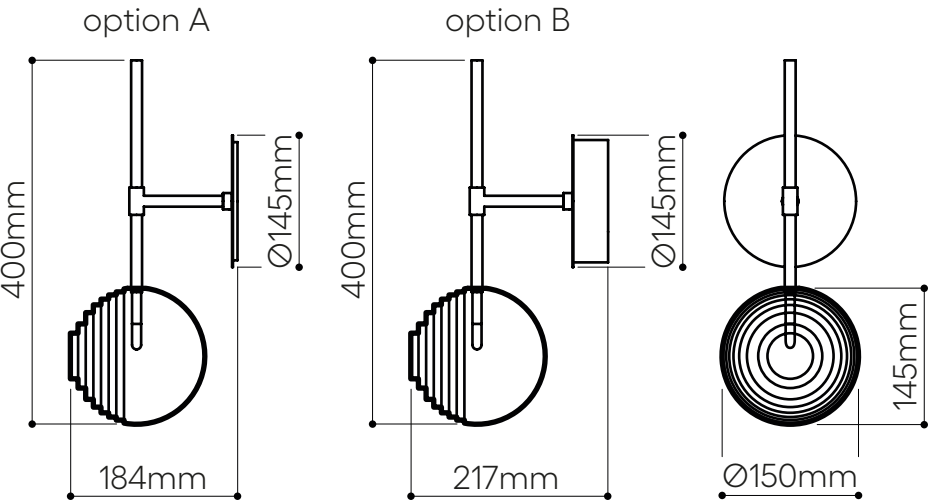

### LIGHTING DESCRIPTION

Size	150 × 184 (217) × 400 mm 5,9 × 7,24 (8,5) × 15,75 inch
Weight	+/- 2,5 kg / 5,5 lb
Glass	mouth-blown lead-free crystal in dark and bright
Mounting	brushed silver (brushed stainless steel) brushed gold (brushed stainless steel gold nitridated)
Recommended junction box	EU - A.UK1-SH (72mm dia, 60mm min. depth) UL/The Americas - electrical box, Octagon, 4 X 4 inch (1,4 inch min. depth)
Protection	IP 20
Nominal voltage	220-240V A.C. 50 hz (EU) 110-120 V A.C. 60 Hz (USA)
Class	II, EU / I, USA

### LIGHT SOURCE

Type	G4, 1,2W LED, 100 lm
Base	G4 (EU) / G4 (USA)
Voltage	12VDC, 100mA
Temperature	2700 K
Color index	RA 90+

Dimming  
EU/Other versions - non-dimmable  
UL/The Americas - TRIAC, ELV

### TRANSFORMER

Primary	100-240V, 50/60 Hz
Dimmer	12VDC, +/-0,5A, 5W

### PACKAGING

Material	Cardboard
Size	220 × 220 × 250 mm 8,6 × 8,6 × 9,8 inch

Origin: traditionally produced in the Czech Republic  
Intellectual property license holder: Bomma Czech Republic (EU)  
Represented by BMRC group s.r.o.

### CERTIFICATES

